

RENATA POCZTARUK

**DETALH
AMENT
O PARA AR
QUITETOS**

ARQ**EXPRESS**





Vocês já pararam para pensar que o detalhamento que a gente projeta na casa do cliente afeta diretamente o dia a dia dele?

Não existe sensação pior do que esquecer o espaço para alguma coisa na casa de um cliente! Projetar uma Lavanderia sem ter espaço para guardar balde ou vassoura não funciona, certo?

Já pensou um armário sem gavetas para guardar meias e calcinhas?! Antes de iniciar um detalhamento, precisamos entender as necessidades do cliente, a finalidade do móvel, cada detalhe a ser projetado!

Marcenaria, modulados, planejados, não é um item que se troca com facilidade, então, pessoal, precisamos ter muito cuidado na hora de projetar!

Cada vez mais me espanto com a preocupação das pessoas em gerarem imagens fantásticas, trabalharem com softwares de alta qualidade e deixarem de lado a parte técnica, a parte construtiva! Nada adianta um render que brilhe os olhos se depois o projeto não pode ficar de pé!

Detalhamento é fundamental, eu **amo** detalhar e, por isso, mais uma vez, resolvi compartilhar um pouco do meu conhecimento com vocês! Não sou expert, mas todos estes detalhes já foram de fato aplicados! Este **guia** foi criado para despertar ainda mais o interesse no detalhe, afinal, é ele que faz a grande diferença!

PENATA
PROJECTS



UTENSÍLIOS DE LAVANDERIA

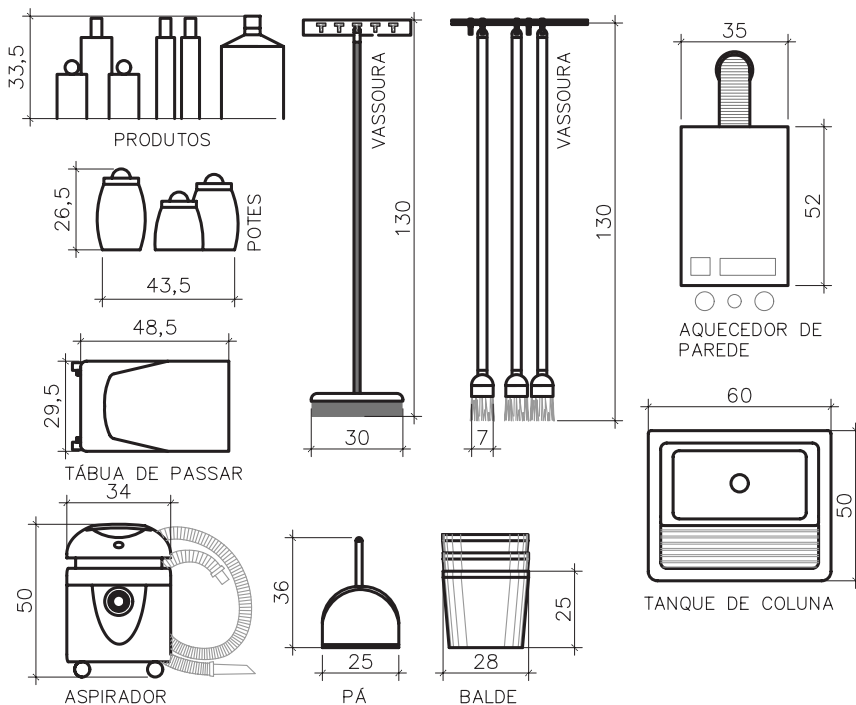

Conheça as necessidades do cliente e dimensões dos utensílios!



PLANTA BAIXA LAVANDERIA

PLANTA BAIXA

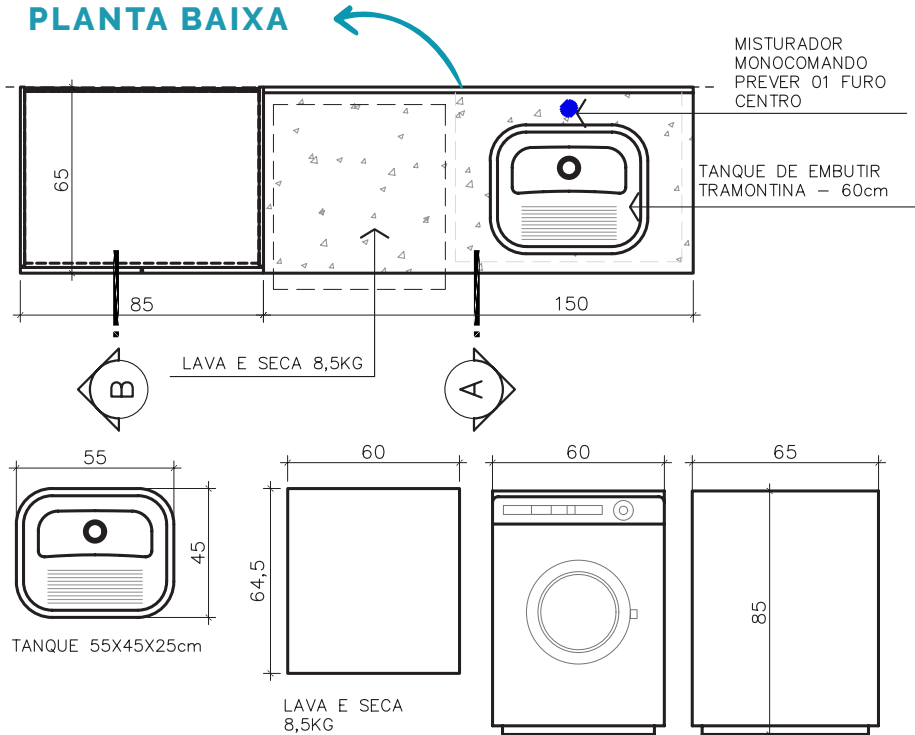

LISTE OS EQUIPAMENTOS

- 1 - Tanque
- 2 - Torneira
- 3 - Eletrodomésticos

EQUIPAMENTOS



VISTA LAVANDERIA

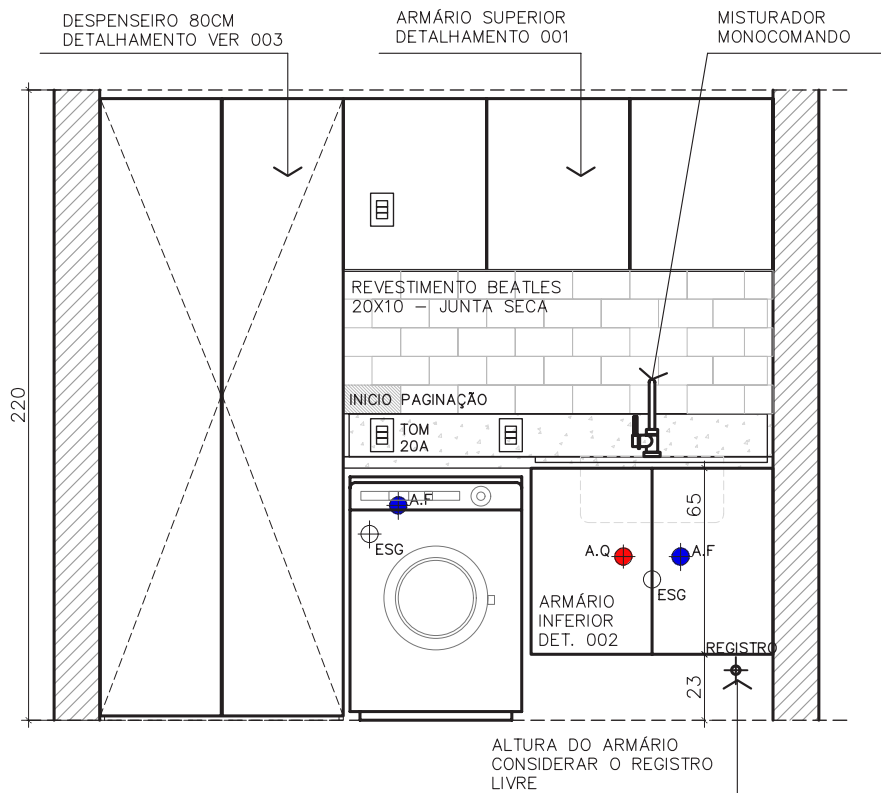

Tudo que você fizer em planta, levante a vista para certificar se está tudo ok!



ARMÁRIO INFERIOR PLANTA BAIXA

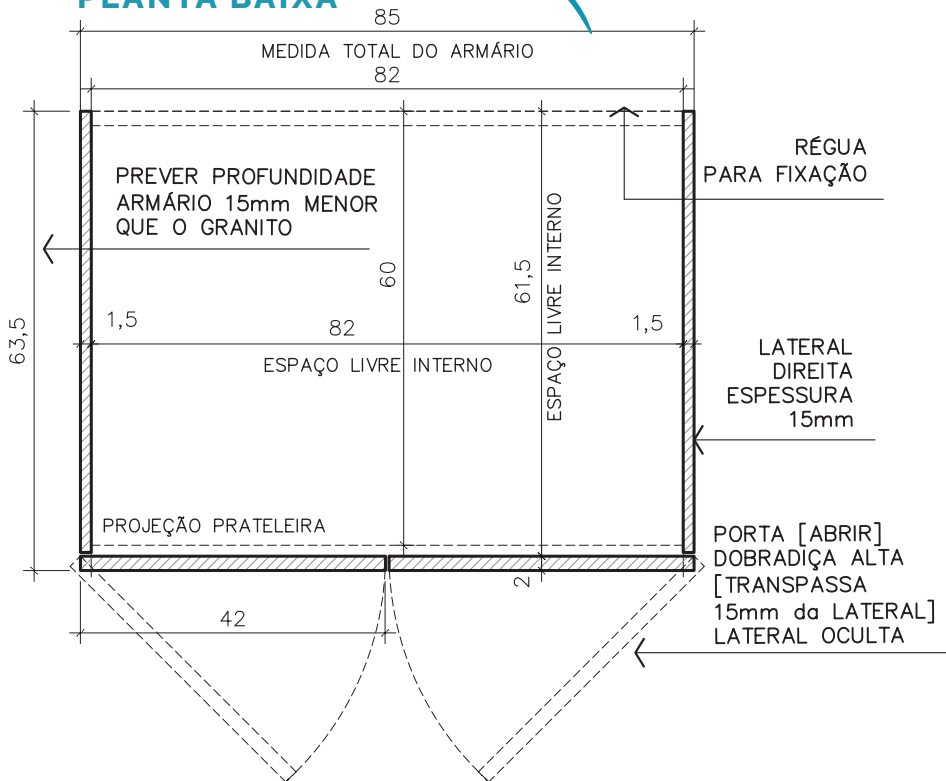

ARMÁRIO INFERIOR PLANTA BAIXA

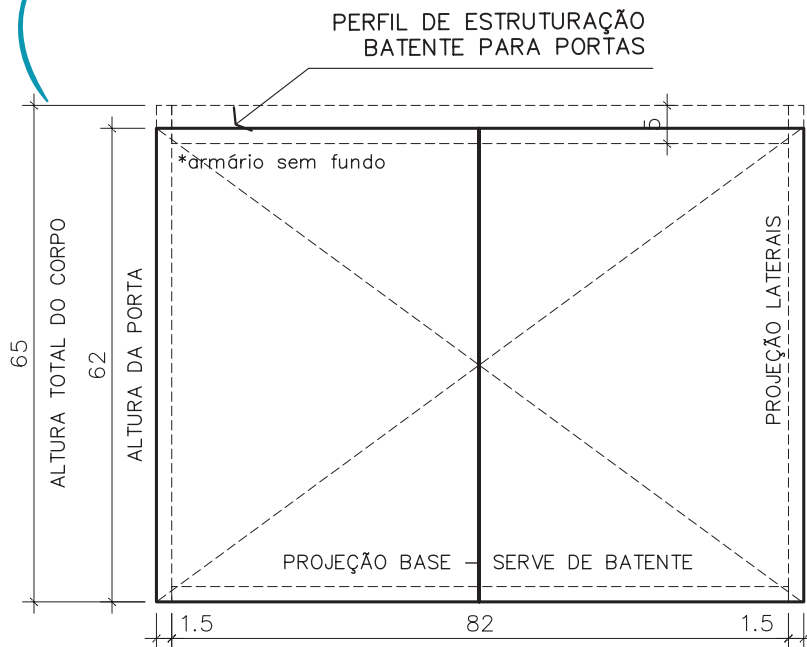

Detalhamento para marcenaria precisa de medidas/dimensões e acabamento conforme o projeto.

ARMÁRIO INFERIOR: CORTE

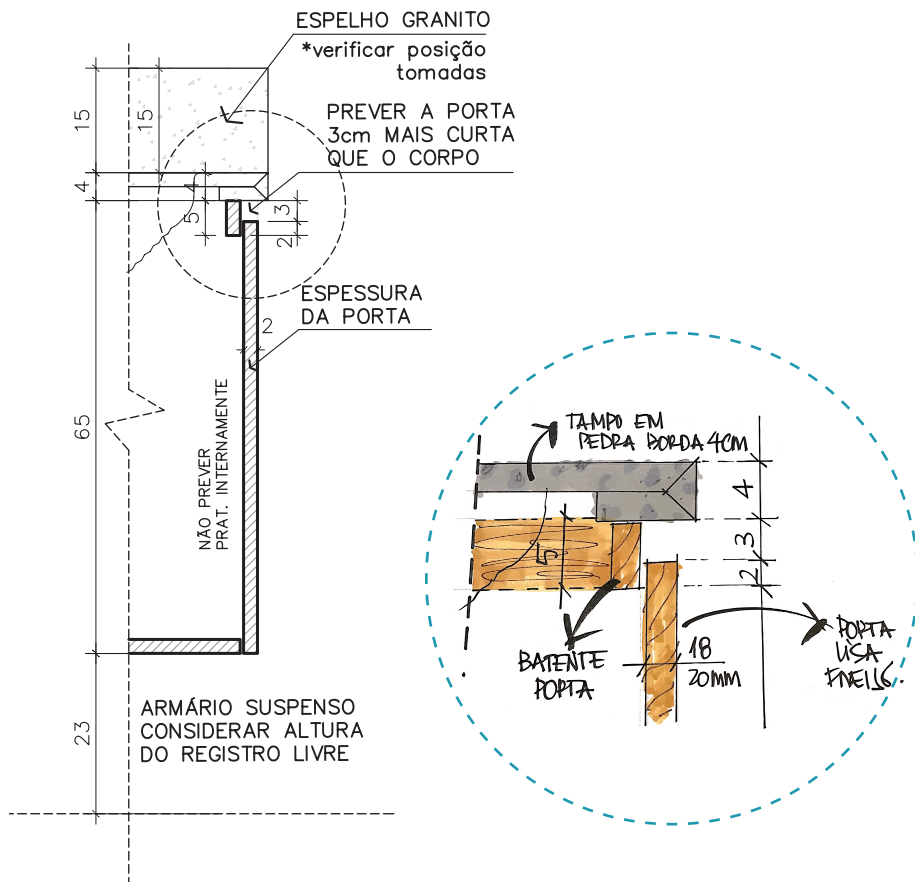

DETALHE 002

CORTE LAVANDERIA

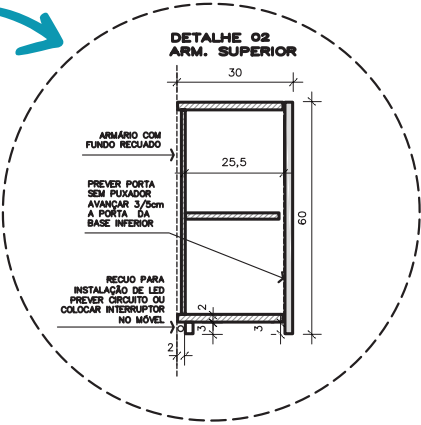
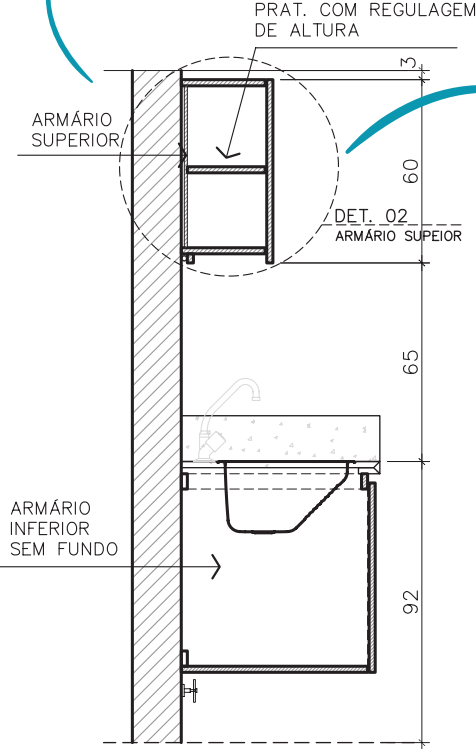

Como a planta, o corte é uma representação da construção. O corte mostra a dimensão vertical de um projeto, como altura, pé direito e outros detalhes que não são representados em planta baixa.

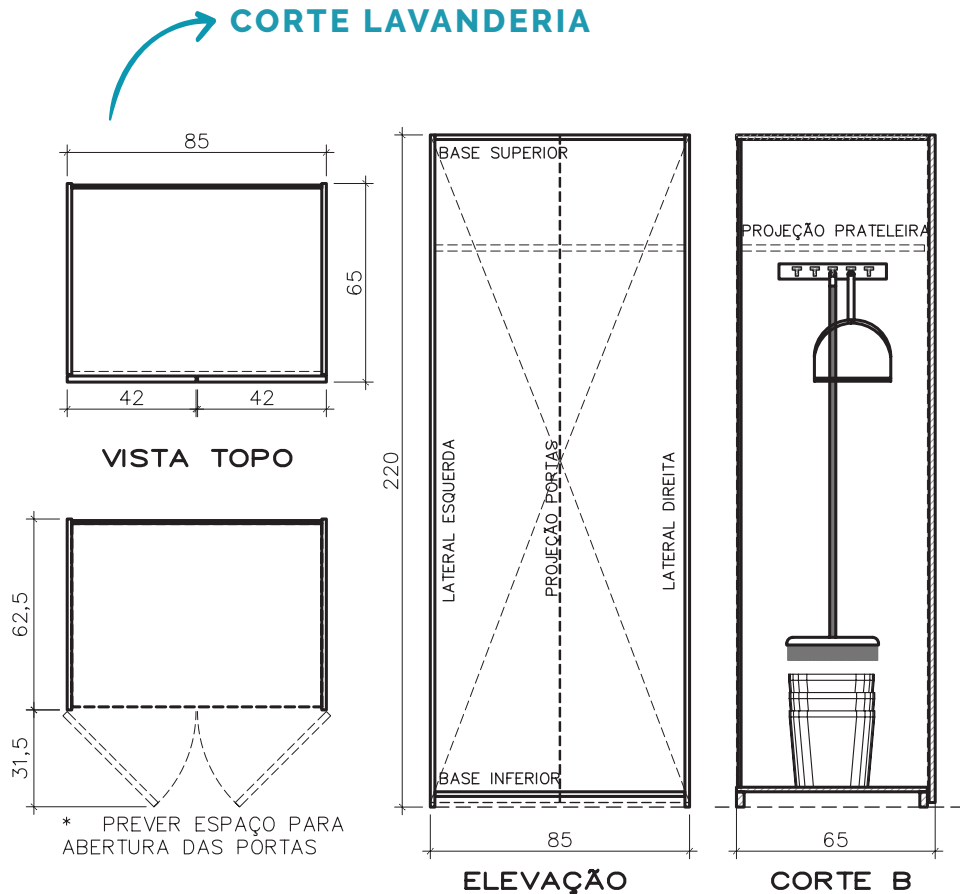

DESPENSEIRO

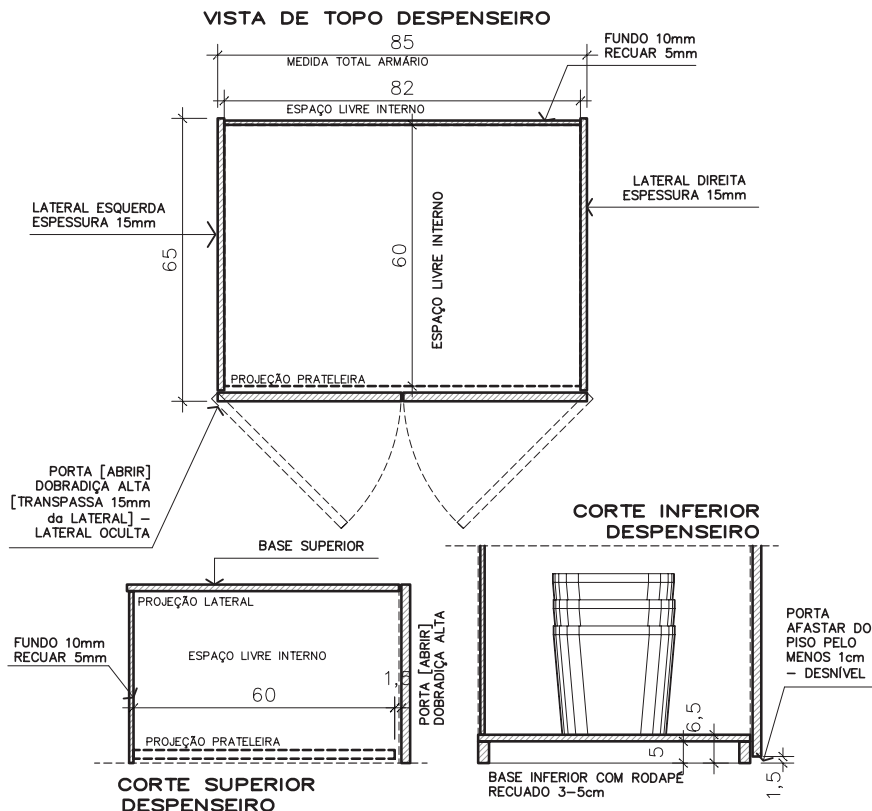

Faça previsão dos espaços de acordo com o uso!

PAINEL PARA TELEVISÃO

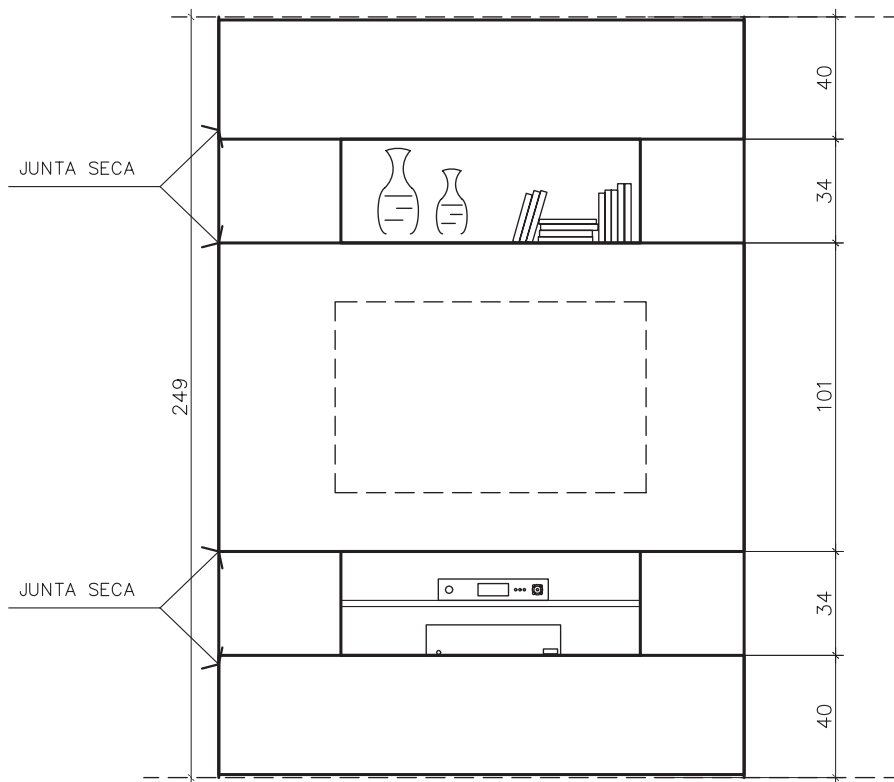

Não quer fios aparecendo? Um painel pode ser a solução! Neste caso projetamos a TV para frente, assim fica tudo alinhado.

PAINEL PARA TELEVISÃO - CORTE

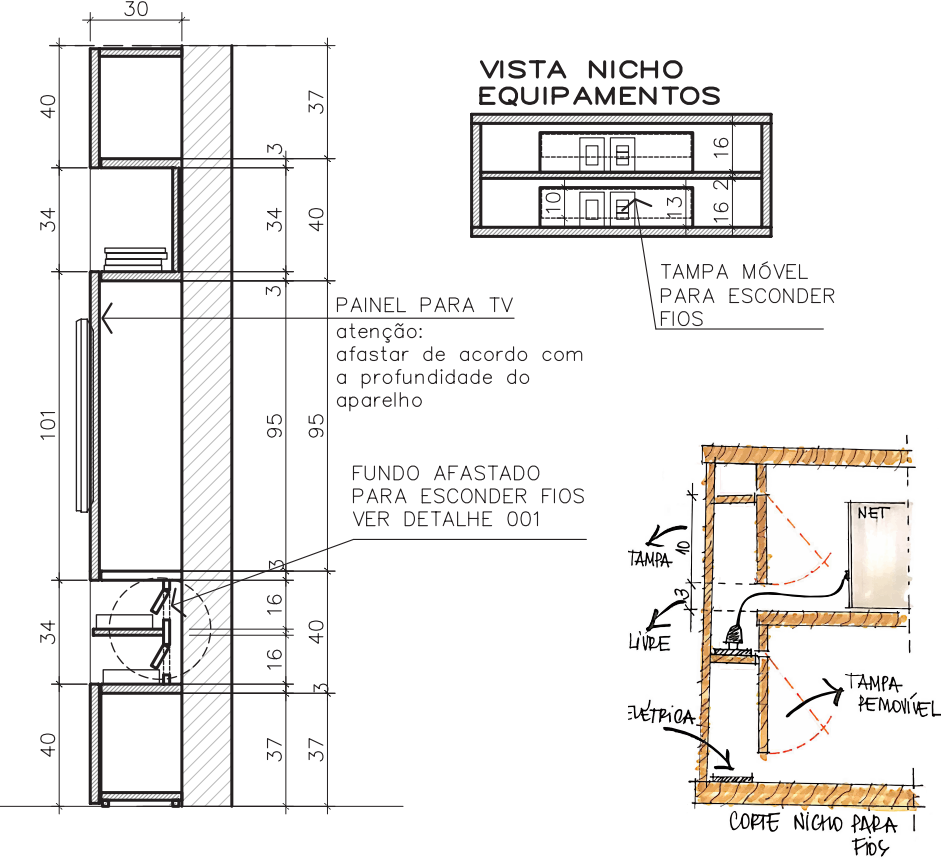

GANCHEIRA - PLANTA BAIXA VISTA SUPERIOR

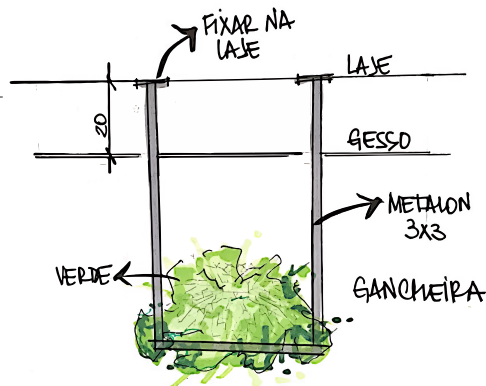
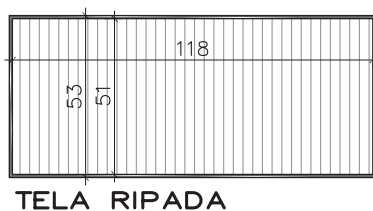
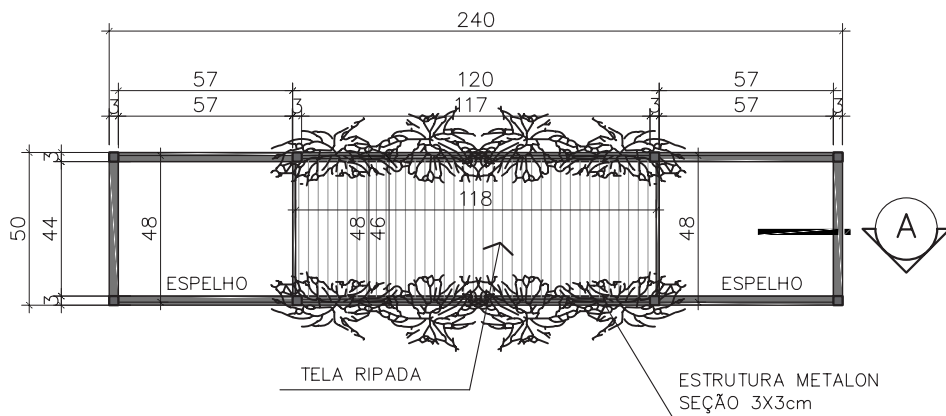

GANCHEIRA - PLANTA BAIXA VISTA INFERIOR

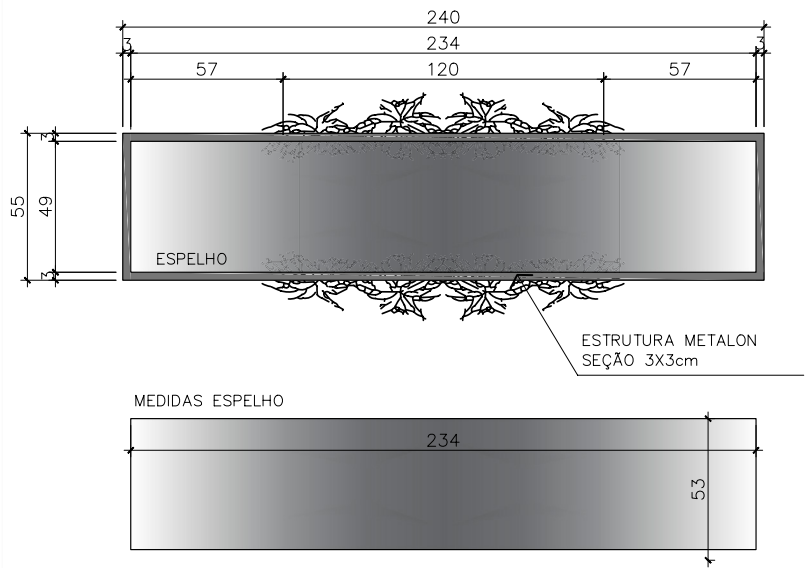

GANCHEIRA - VISTAS

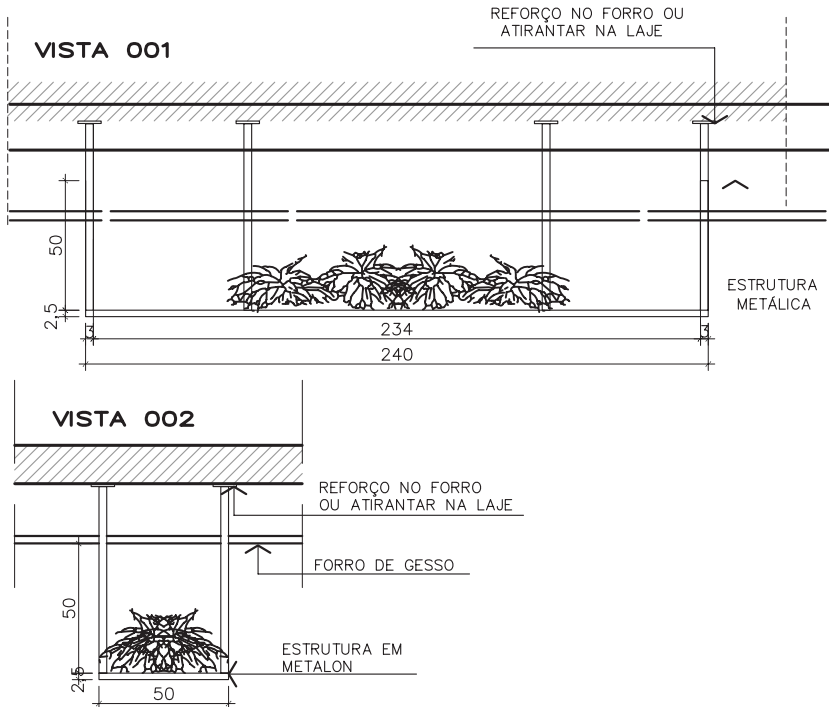

Aquele detalhe que dá todo o charme.♥
Faça reforço no gesso ou prenda na laje!

GANCHEIRA - CORTES

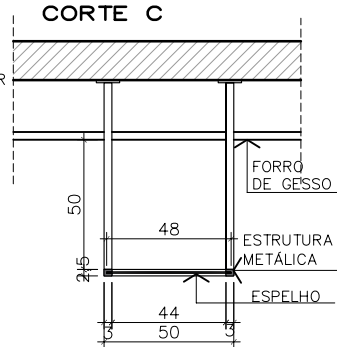
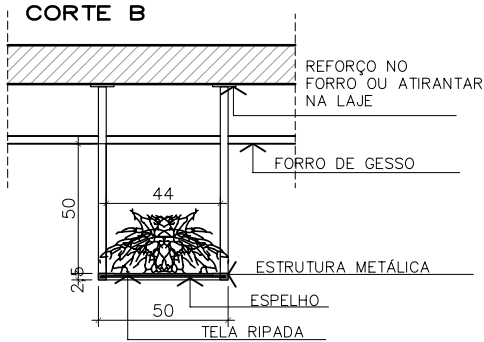
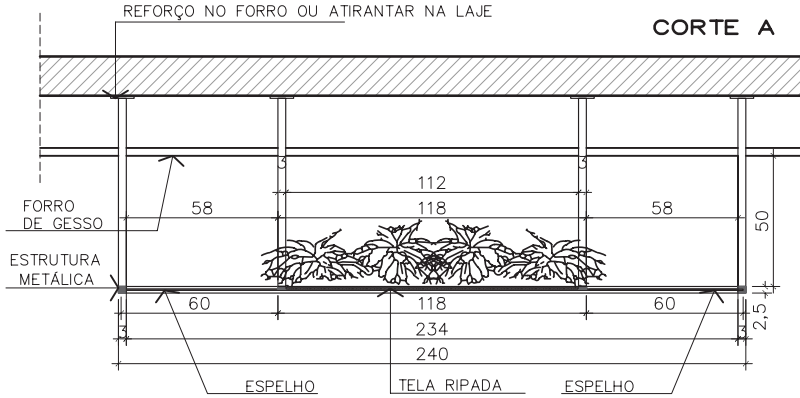

CABECEIRA 001 - PLANTA BAIXA E VISTA

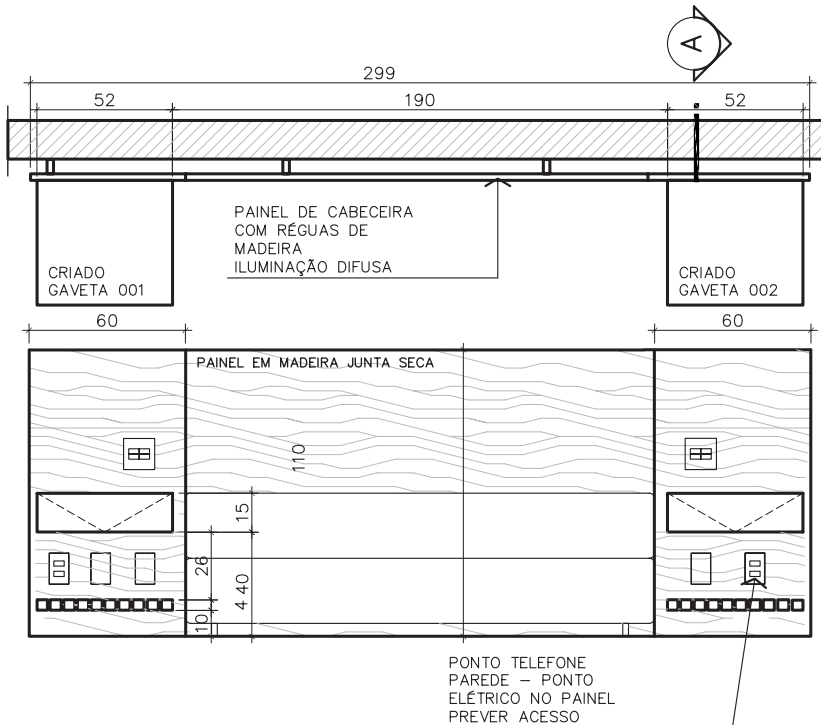

CABECEIRA 001

CORTE

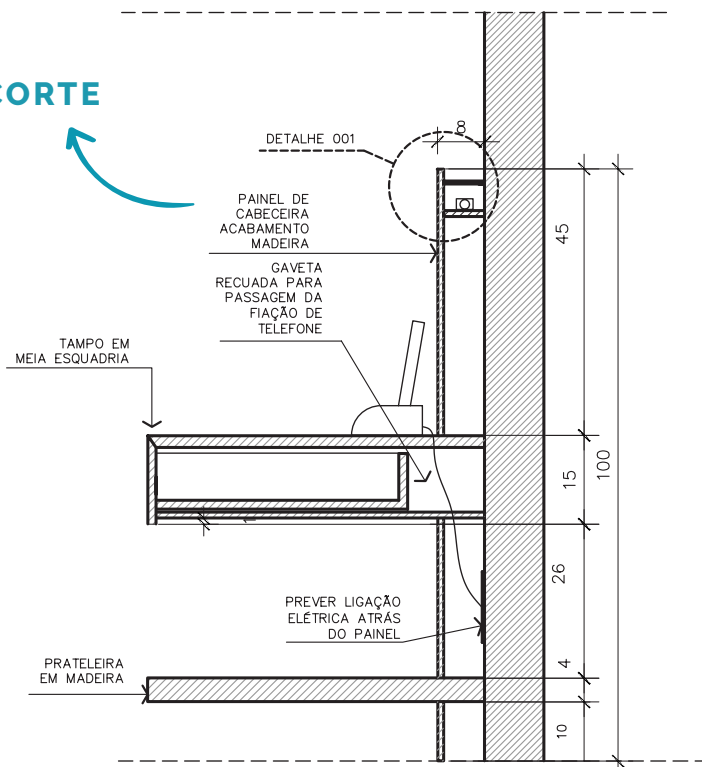

Quer uma luz difusa? Afaste a cabeceira da parede para colocar LED. Mas não esqueça de prever o ponto elétrico e o interruptor!

DETALHE CABECEIRA 001

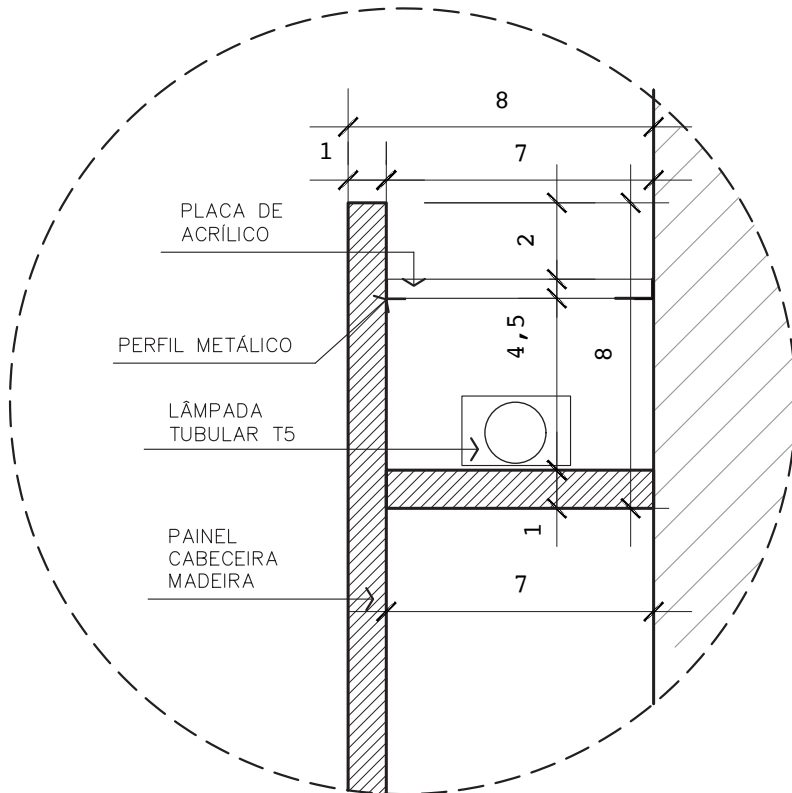

CABECEIRA 002

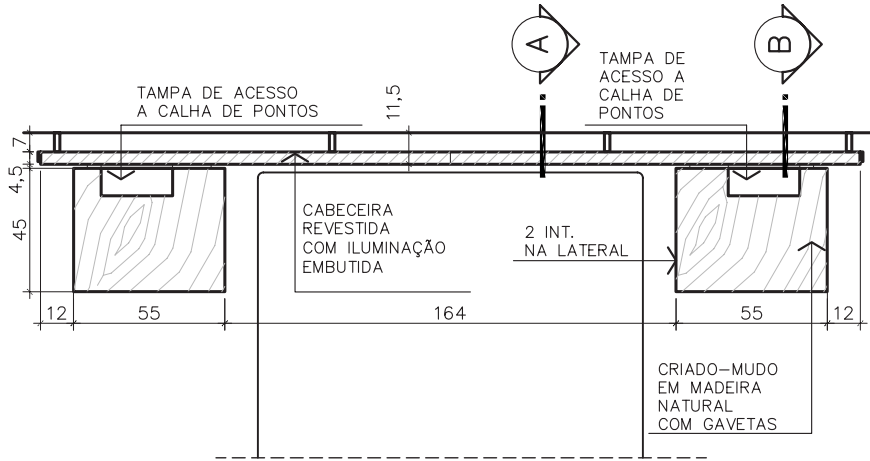

PLANTA BAIXA

CABECEIRA 002

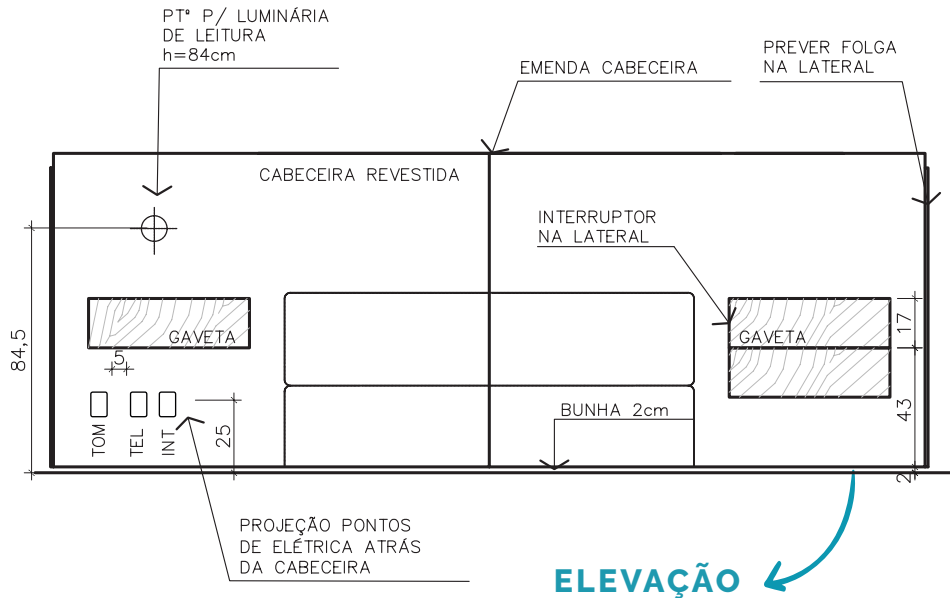

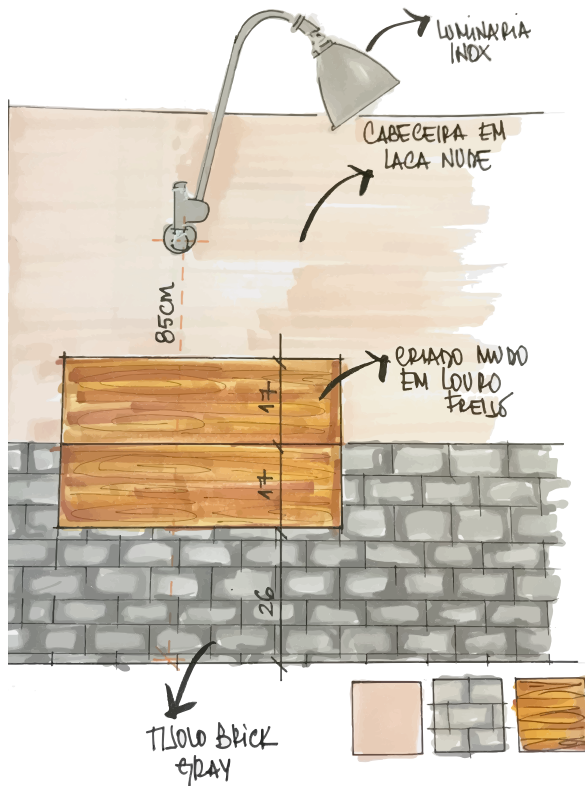

CABECEIRA 002

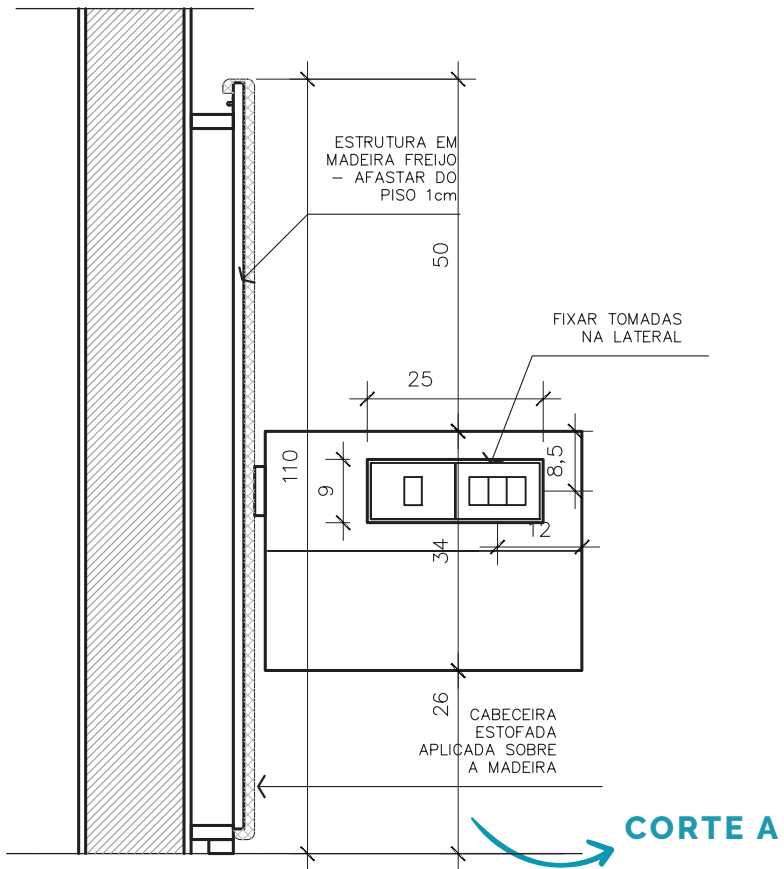

CABECEIRA 002

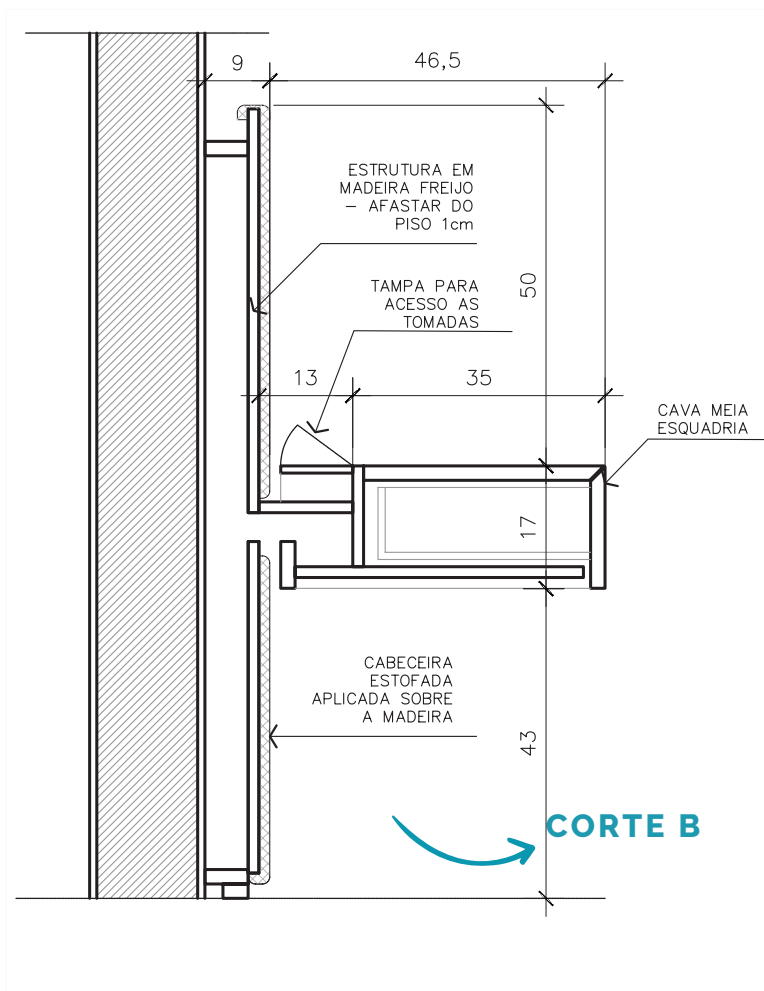

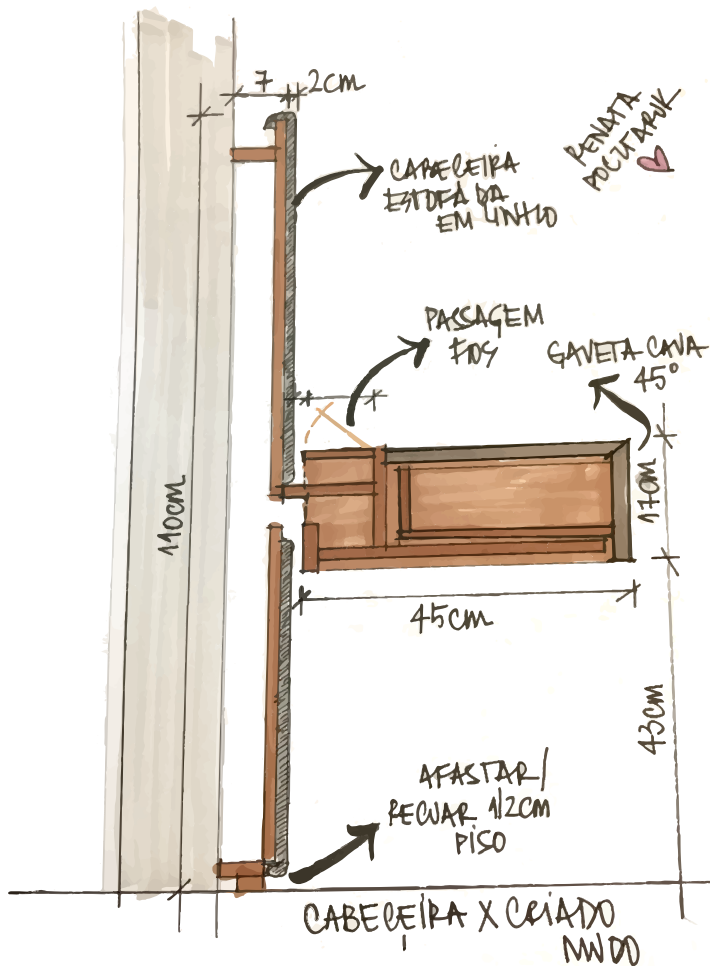

CLOSET - UTENSÍLIOS

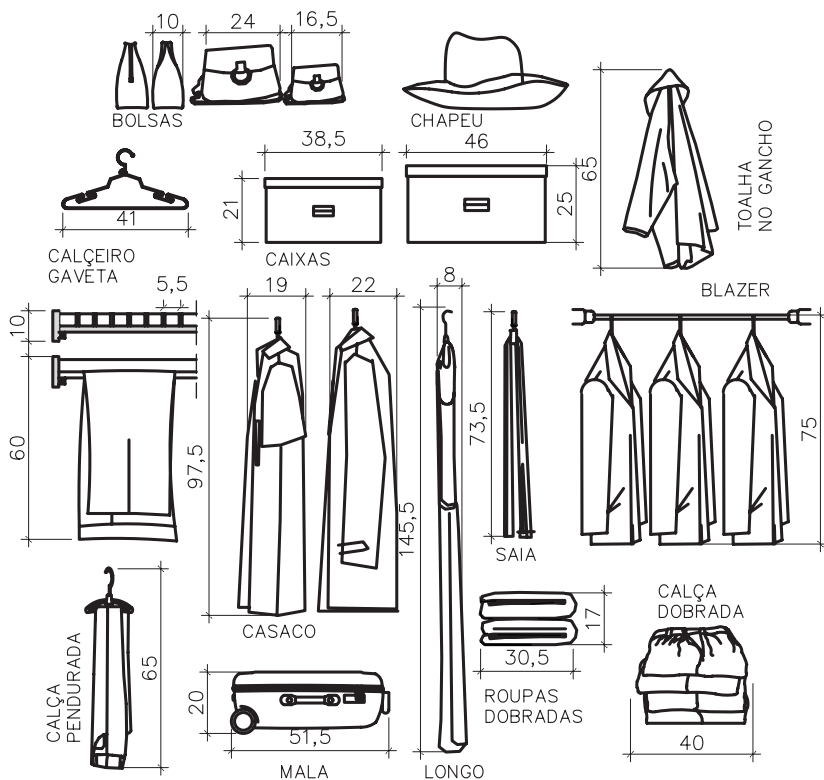

CLOSET

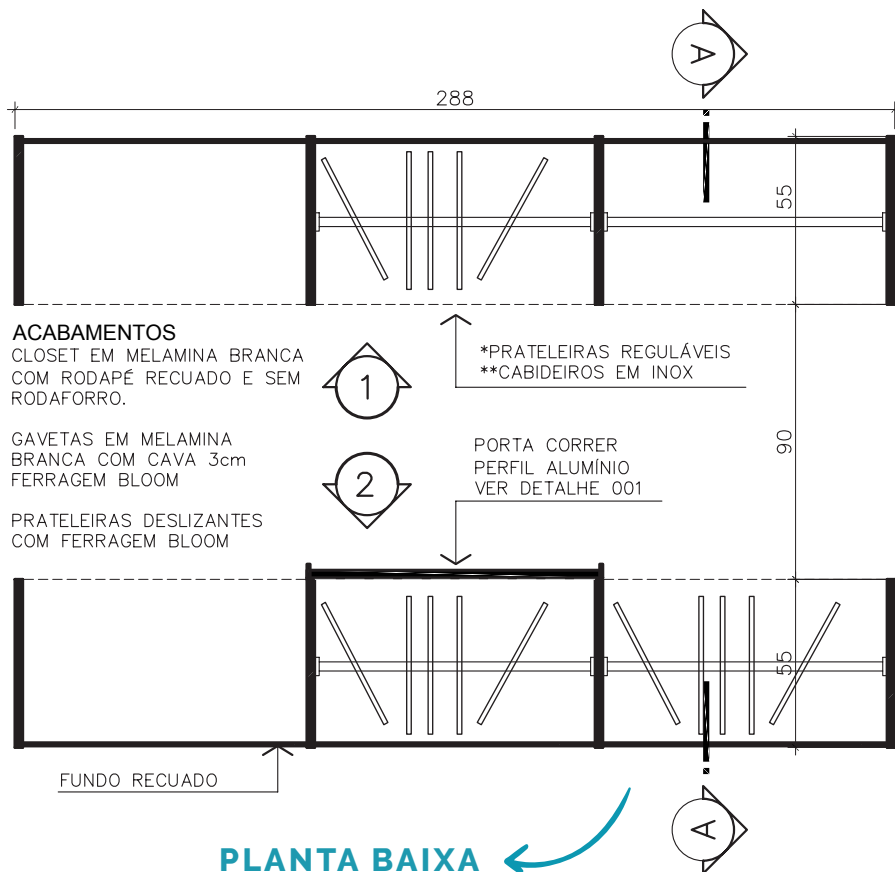

PLANTA BAIXA

CLOSET

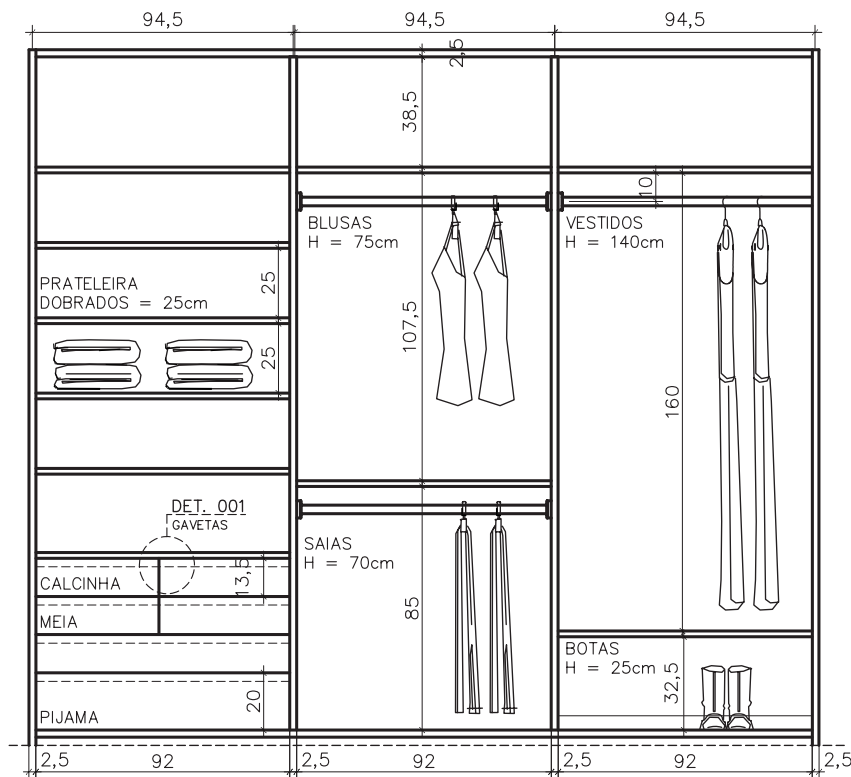

VISTA SEM PORTAS

CLOSET

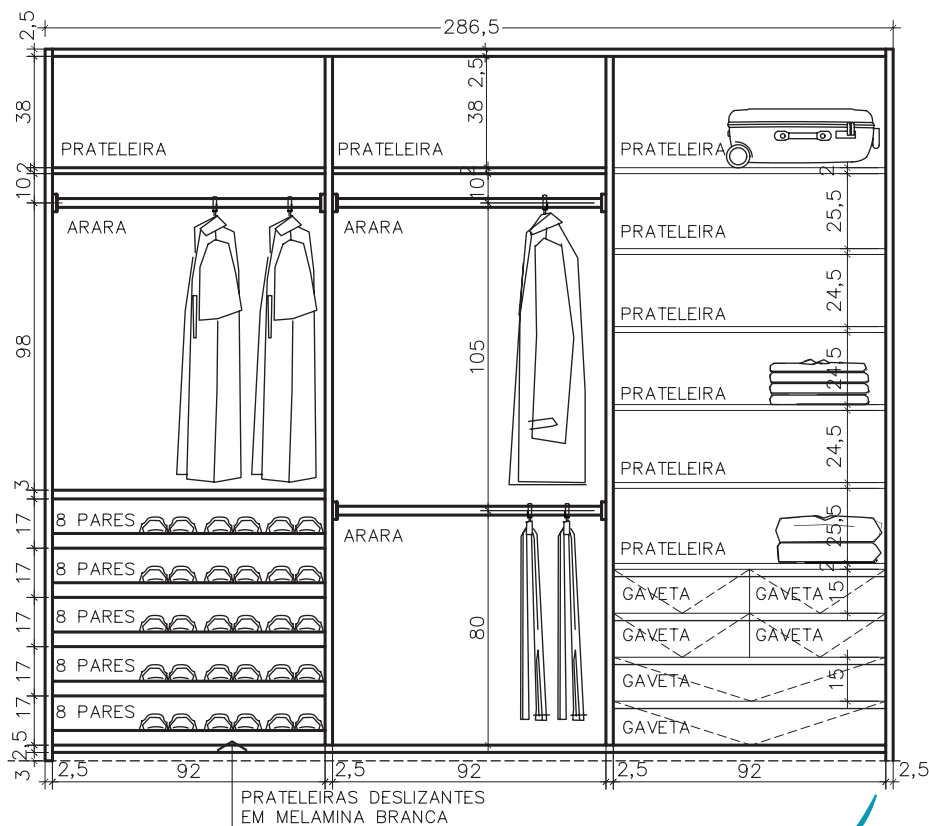

VISTA SEM PORTAS

CLOSET - VISTA - SEM PORTAS

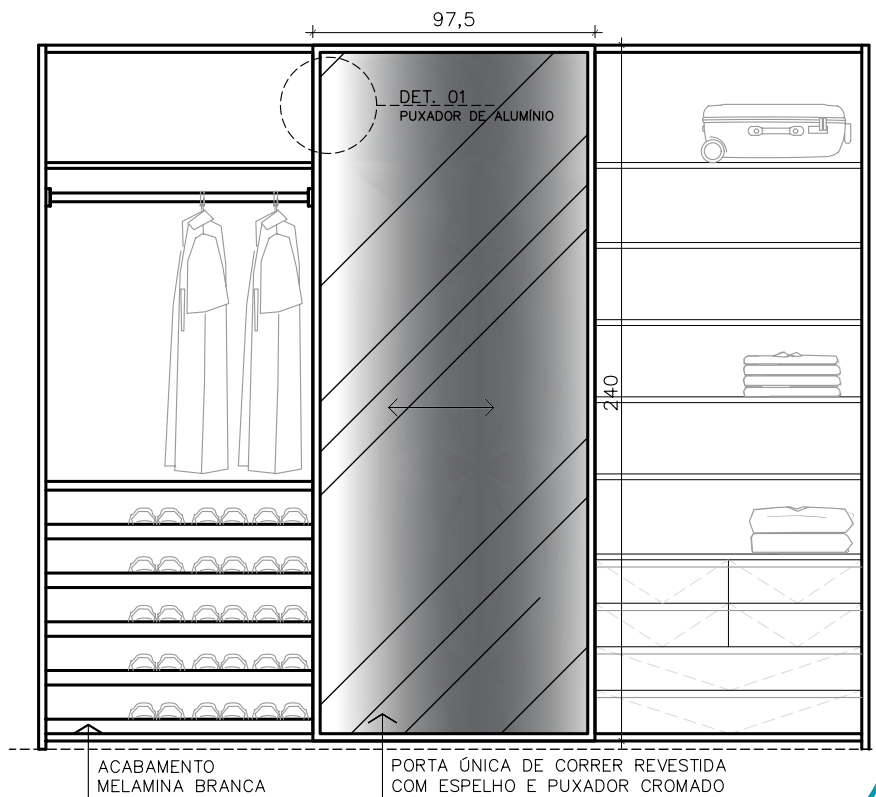

VISTA COM PORTAS DE CORRER

CLOSET

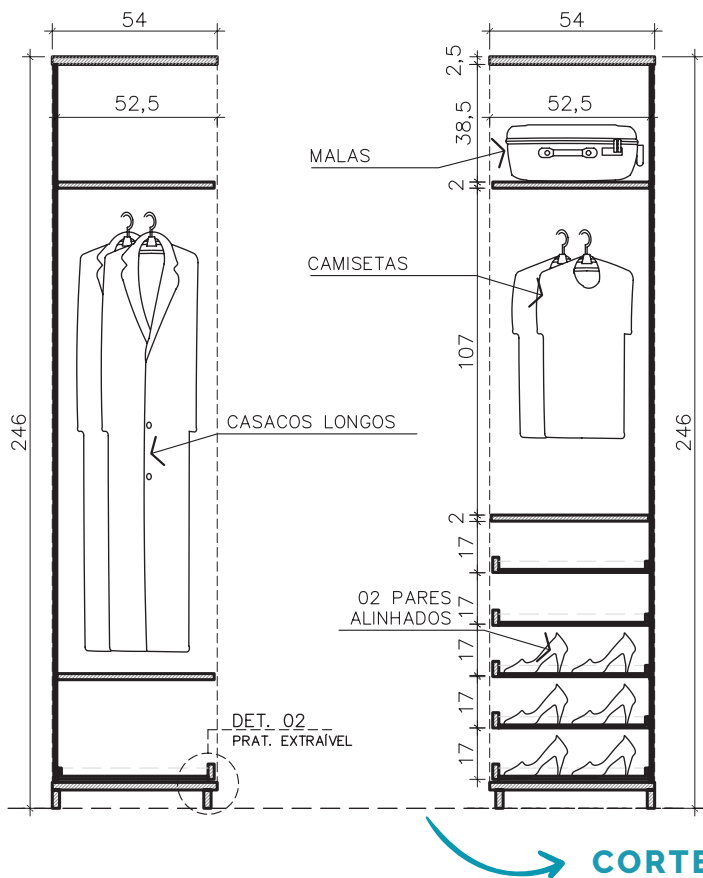

DETALHE PUXADOR DE ALUMÍNIO

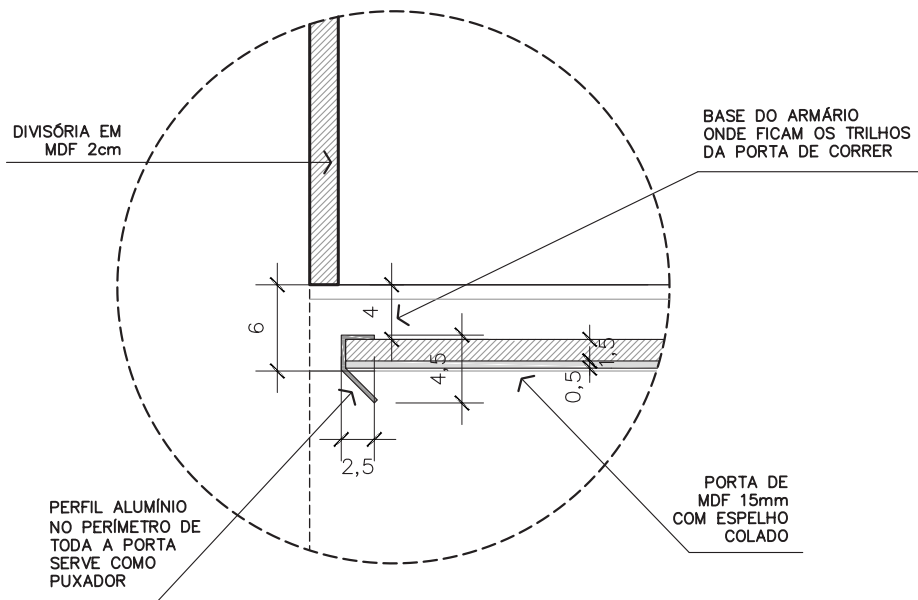

SAPATEIRA - CORTE

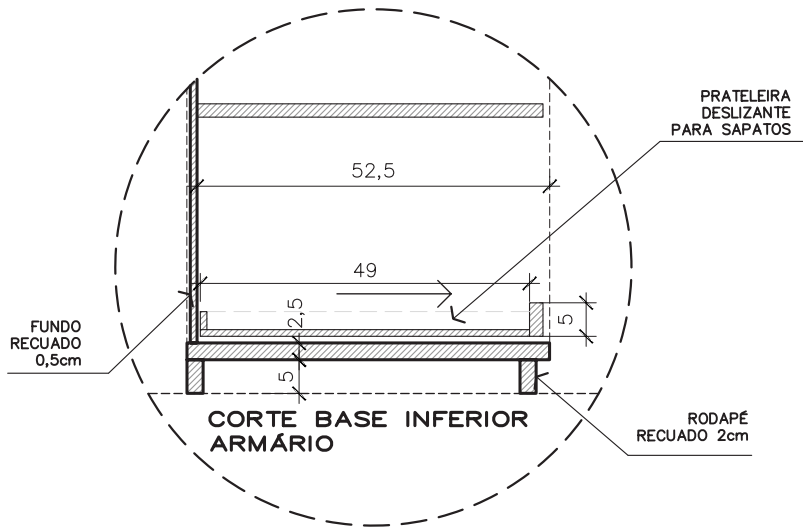

Quantos sapatos o cliente tem? Você perguntou?

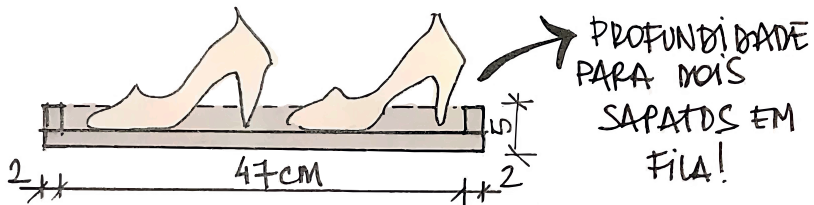

SAPATEIRA - CORTE

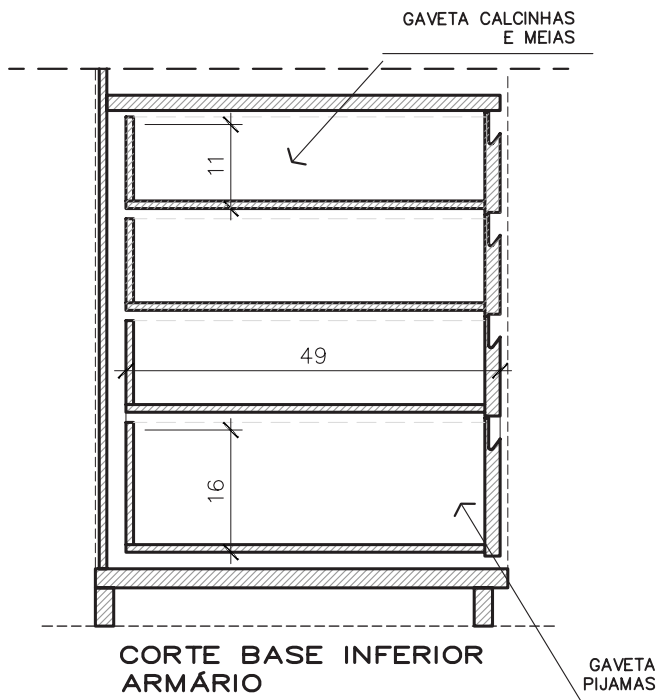

ARMÁRIO COM PORTA DE ABRIR - PLANTA BAIXA

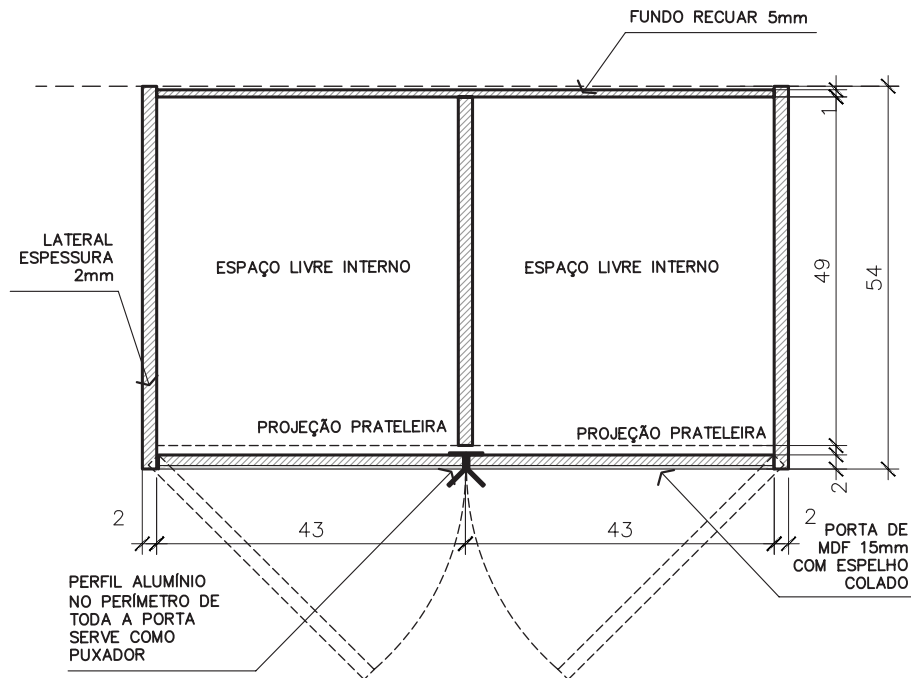

* PREVER ESPAÇO PARA ABERTURA DAS PORTAS E GAVETAS

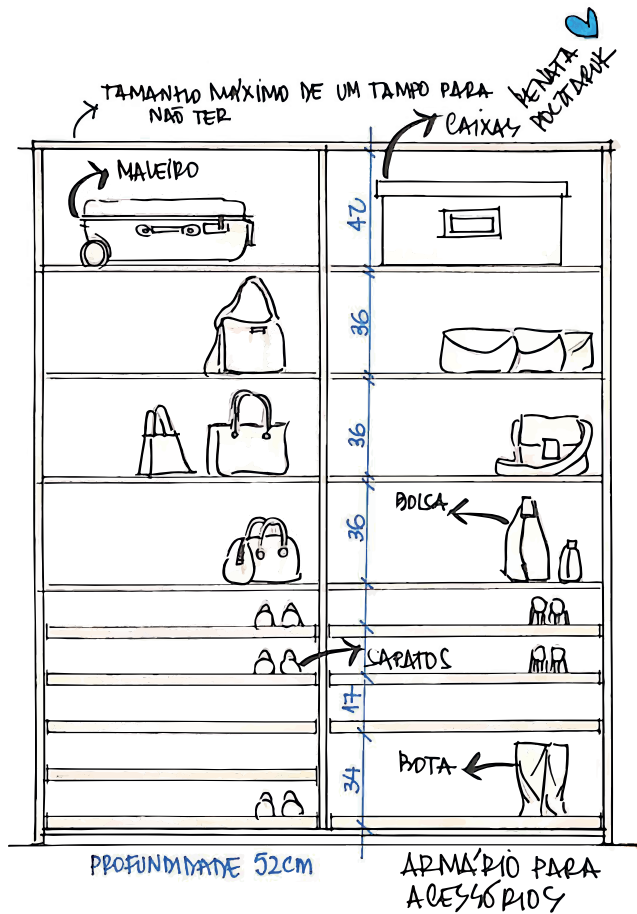

ARMÁRIO COM PORTA DE CORRER - CORTE

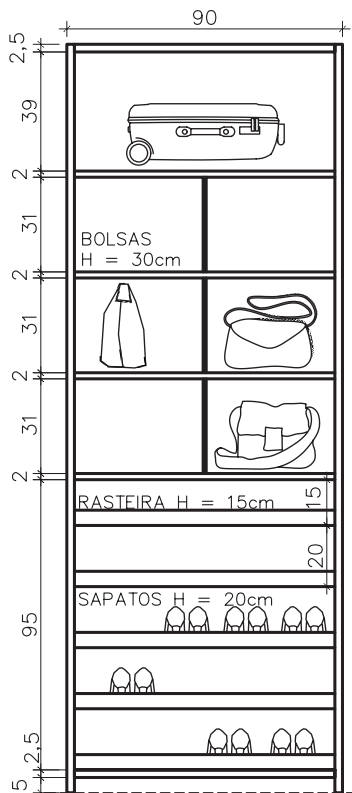

VISTA ARMÁRIO
ACESSÓRIOS

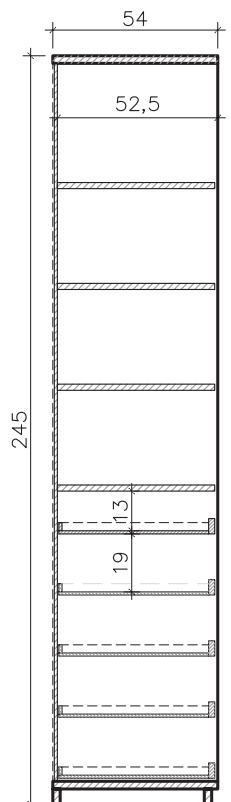

CORTE ARMÁRIO
ACESSÓRIOS

ARMÁRIO COM PORTA DE CORRER

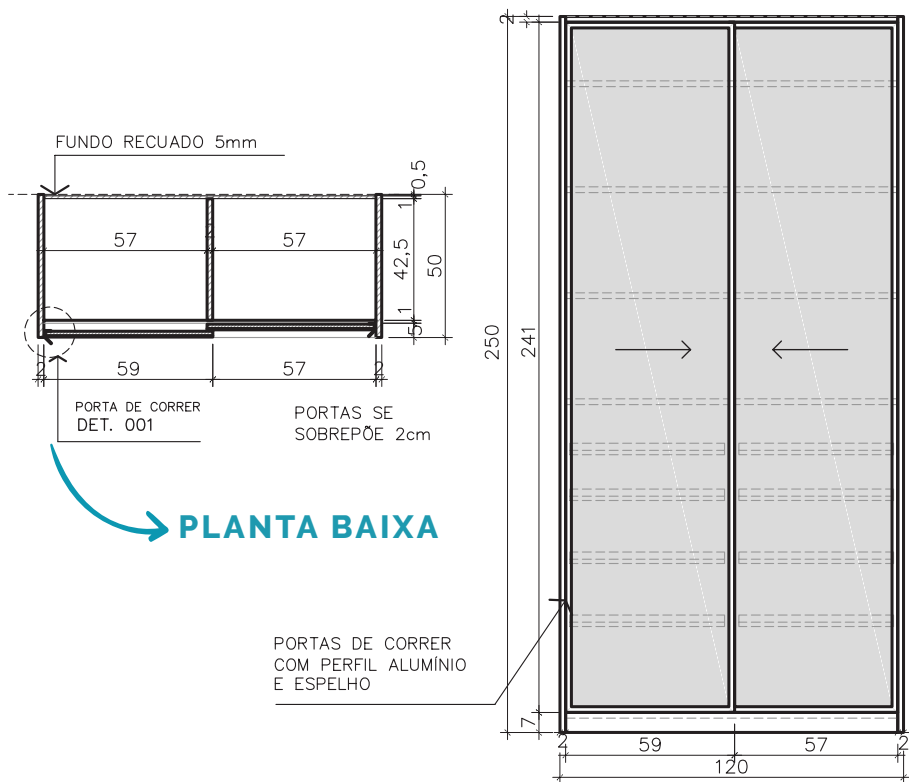

BALCÃO COM PORTAS

PLANTA BAIXA BALCÃO

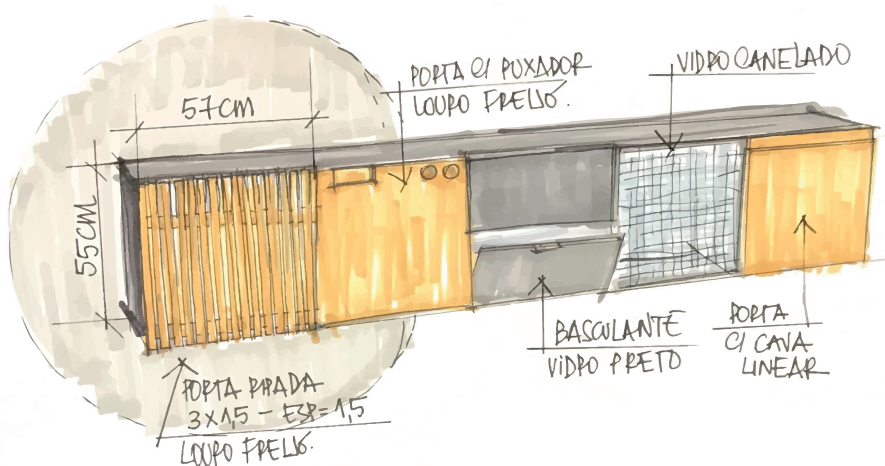
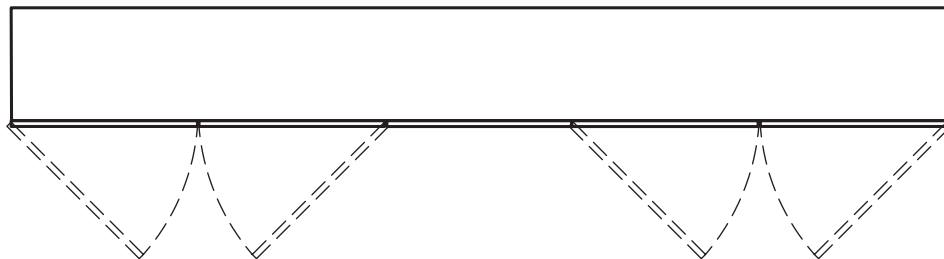

BALCÃO COM PORTAS - PLANTA BAIXA E VISTA

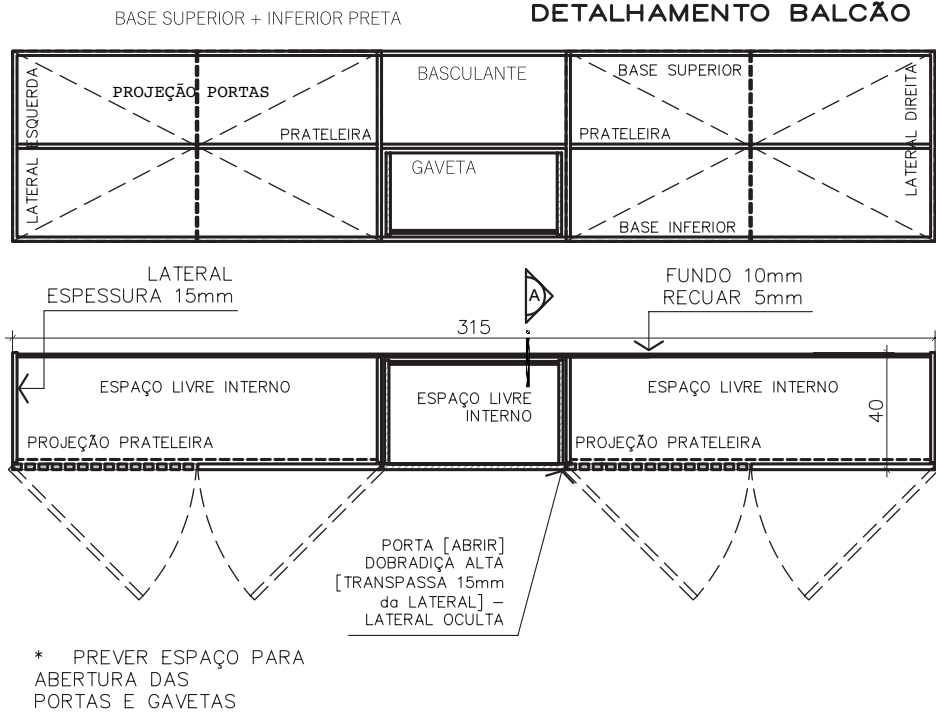

PORTA RIPADA

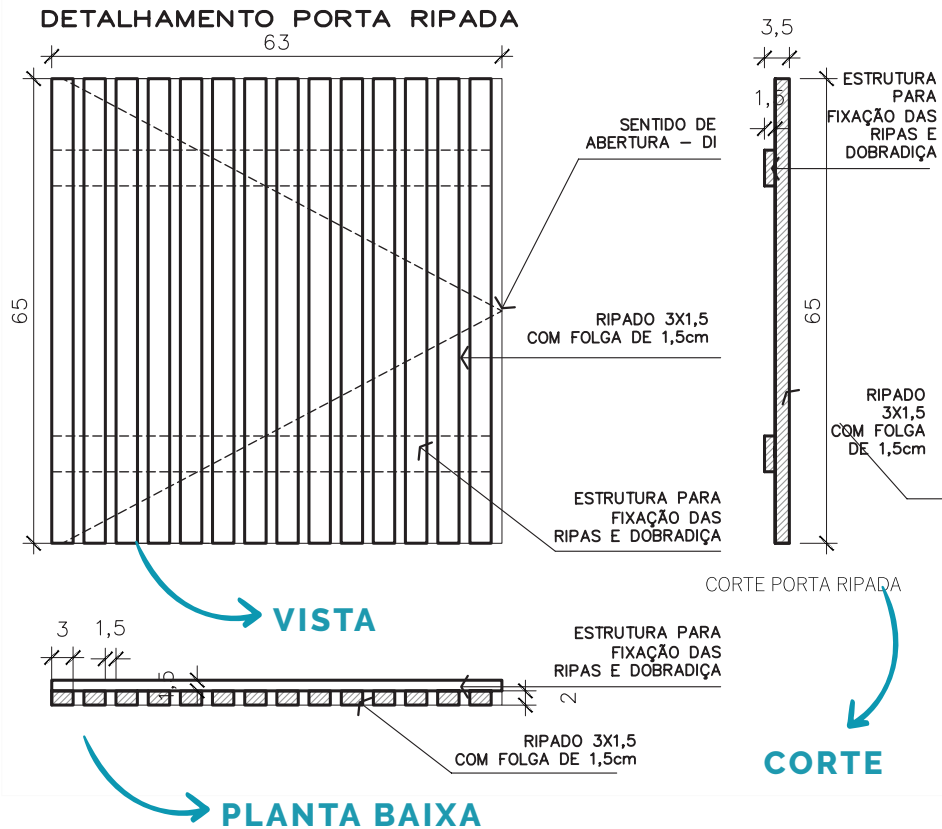

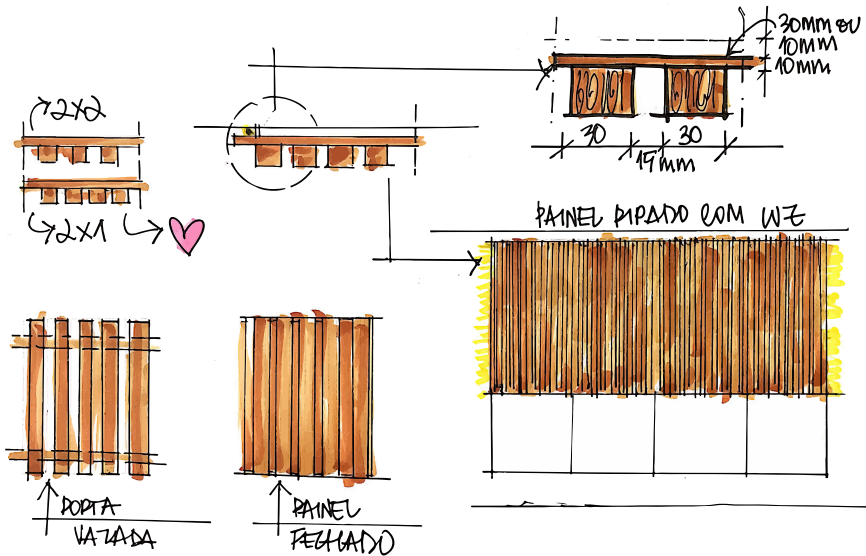

PORTA LISA

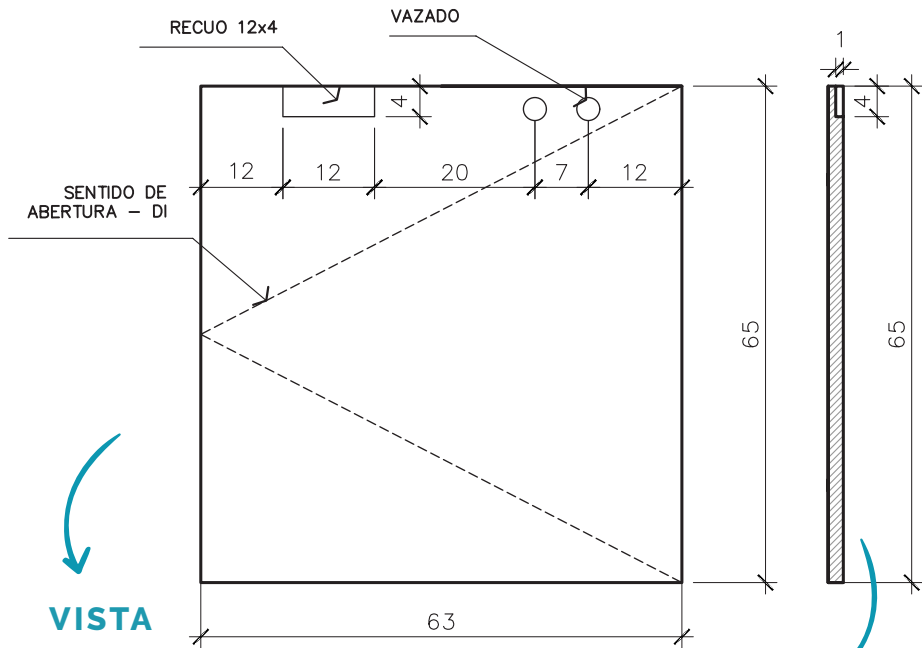

VISTA

CORTE

DETALHAMENTO PORTA LISA

PLANTA BAIXA

MÓDULO CENTRAL

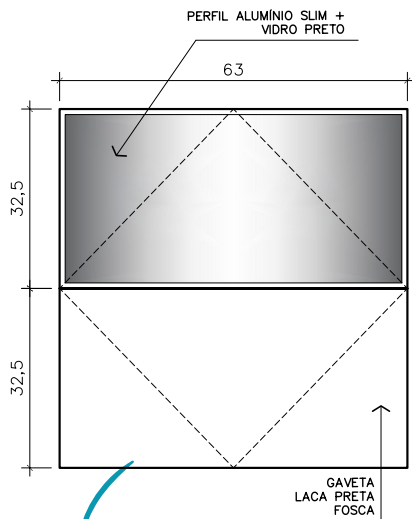

VISTA

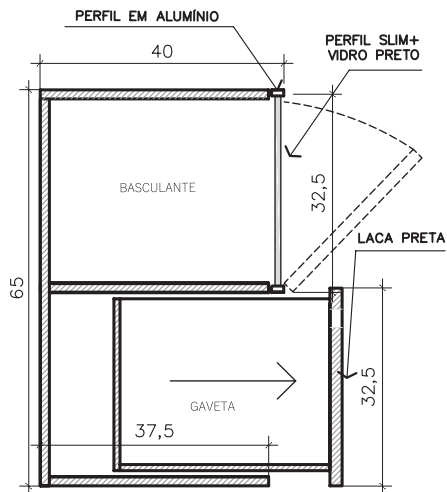

CORTE

CRIADO MUDO - PLANTA BAIXA, CORTE E VISTA

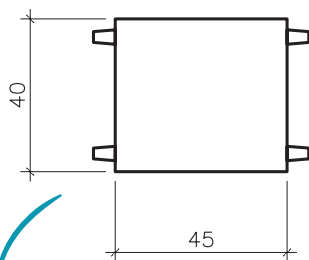

PLANTA BAIXA

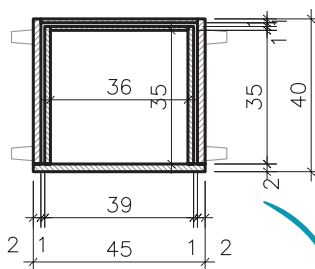

CORTE

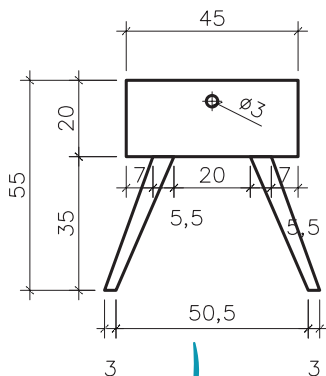

VISTA

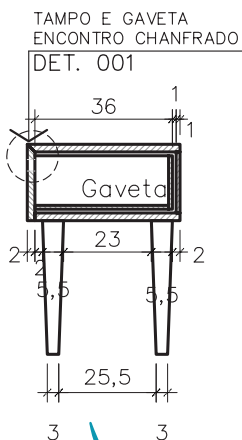

CORTE

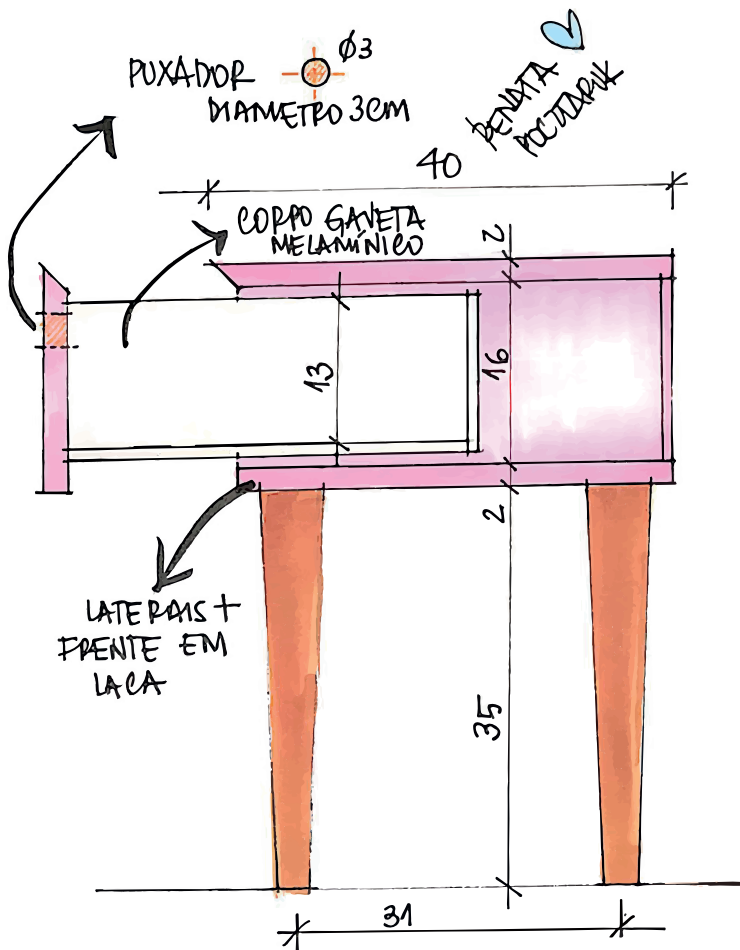

MÓVEL PARA ACESSÓRIOS

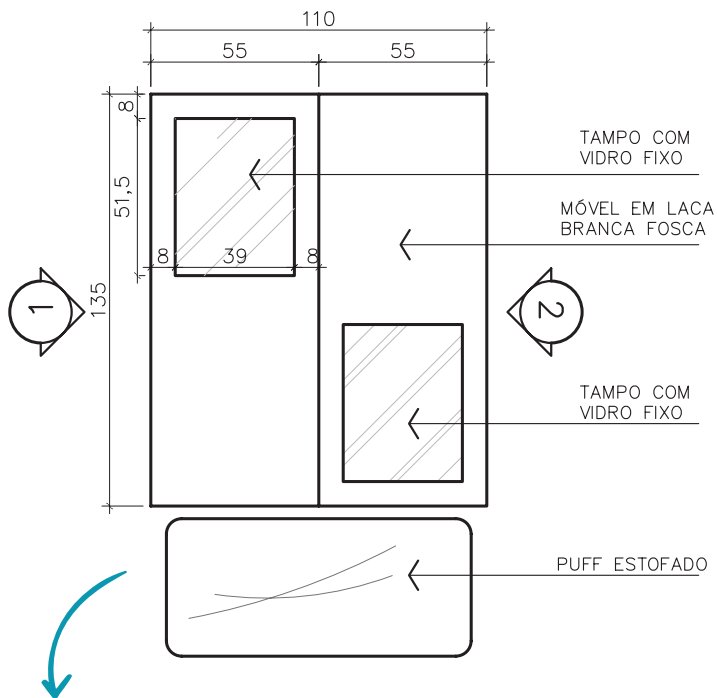

PLANTA BAIXA

MÓVEL PARA ACESSÓRIOS

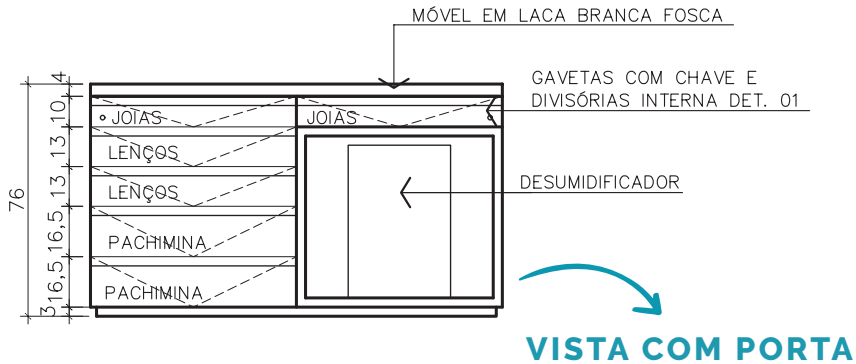

MÓVEL PARA ACESSÓRIOS

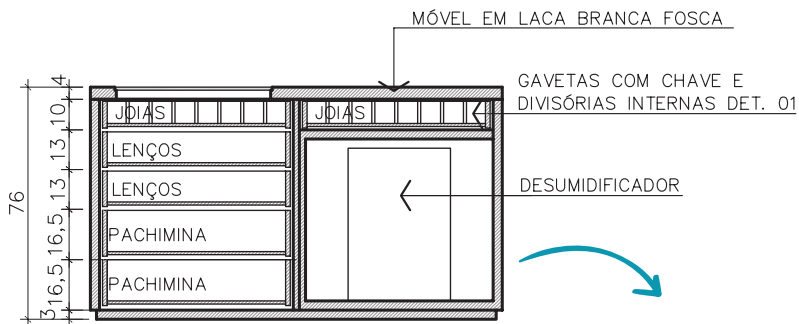

VISTA SEM PORTA

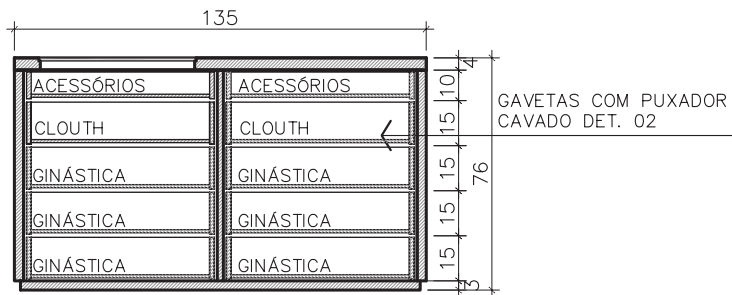

VISTA SEM PORTA

[illegible]

Diagrama de uma gaveta com divisória. A gaveta tem uma largura total de 53,5 cm e uma altura total de 1 cm, dividida em duas partes de 1/2 cm cada. A gaveta é revestida com melamina branca interna e laca branca externa. A divisória é feita de MDF com 2 cm de espessura e também revestida com melamina branca. A frente da gaveta é revestida com laca branca.

ACAB. INTERNO EM MELAMINA BRANCA

**DETALHE
PLANTA GAVETA**

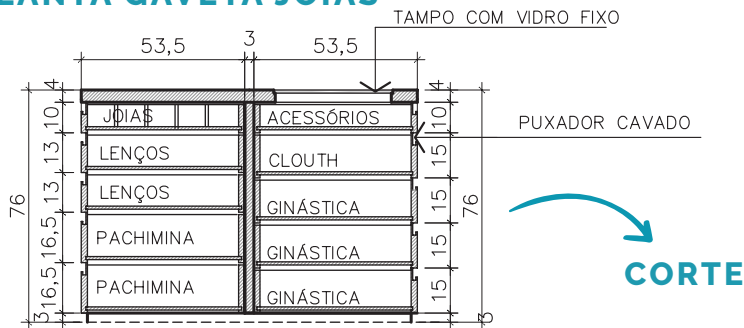

BANHEIRO

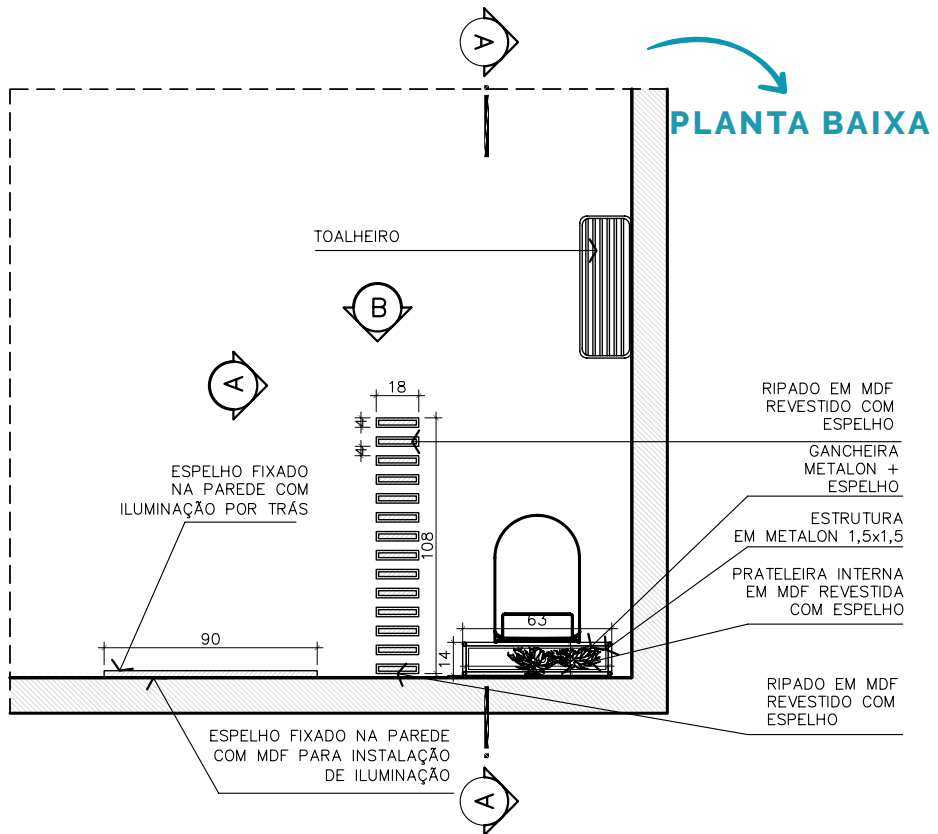

BANHEIRO

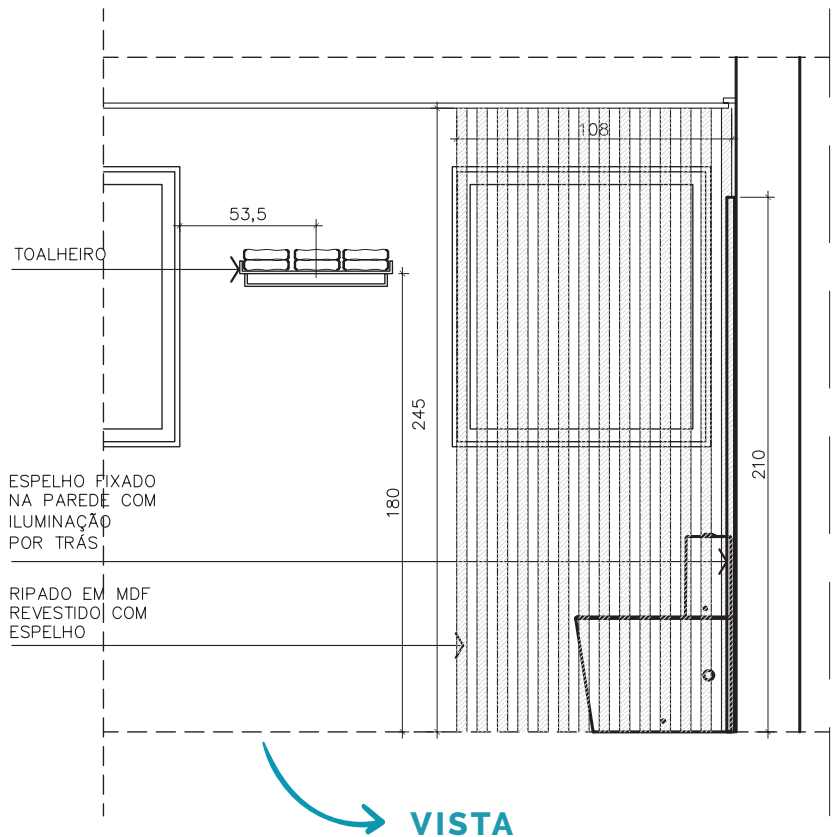



BANHEIRO

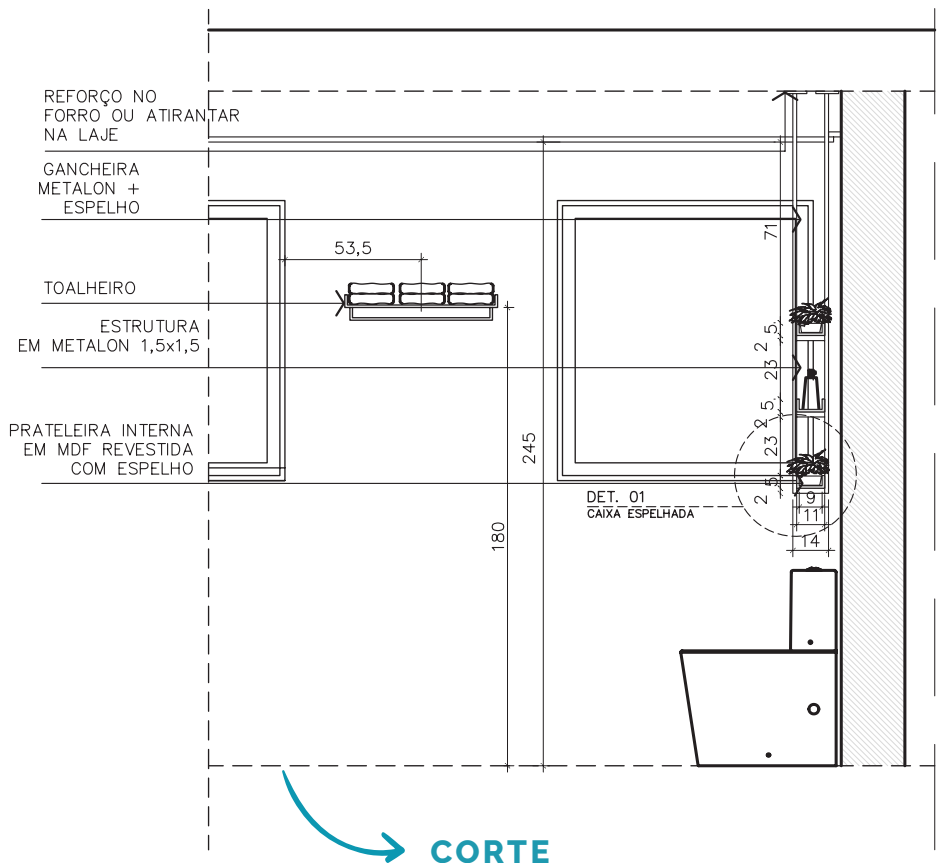

TULHA (BANCADA BANHEIRO)

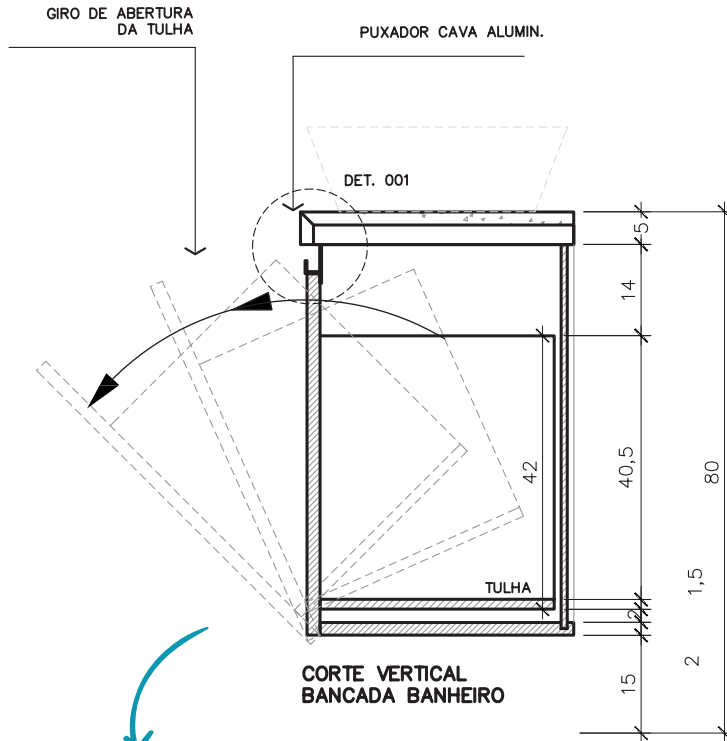

DETALHE ESQUEMÁTICO

DETALHE PUXADOR CAVA

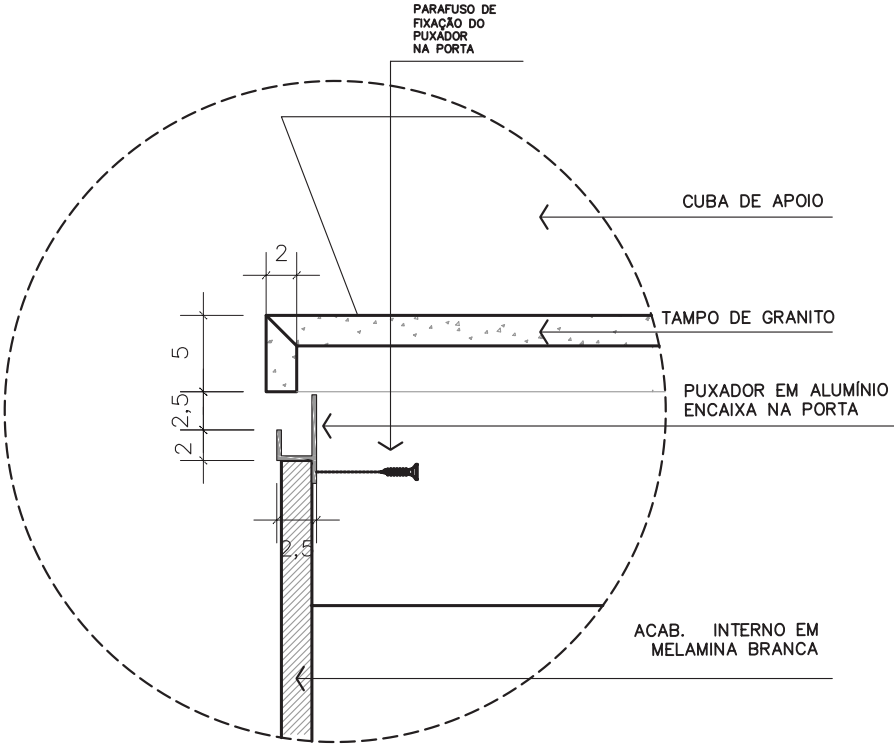

DETALHE GANCHEIRA BANHEIRO

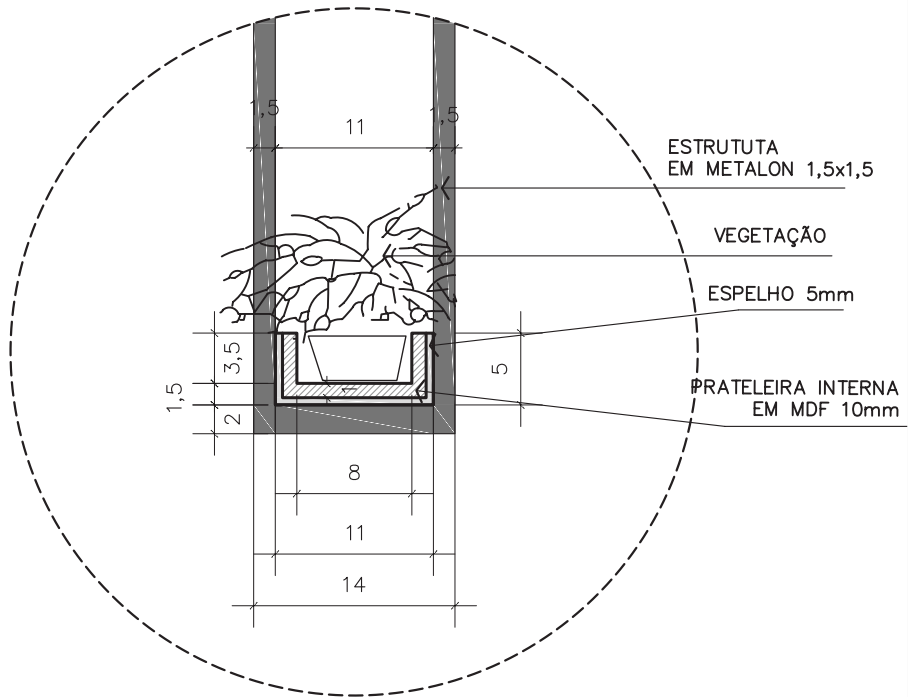

TAMPO E ESPELHO

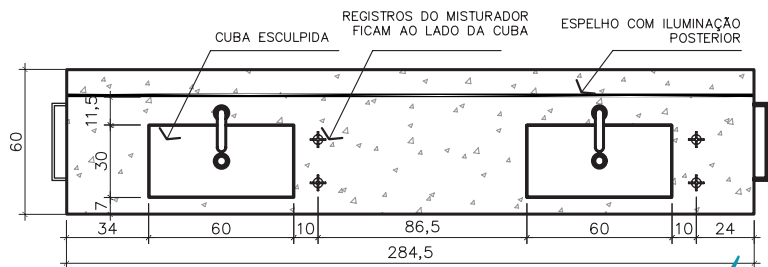

VISTA

PLANTA BAIXA

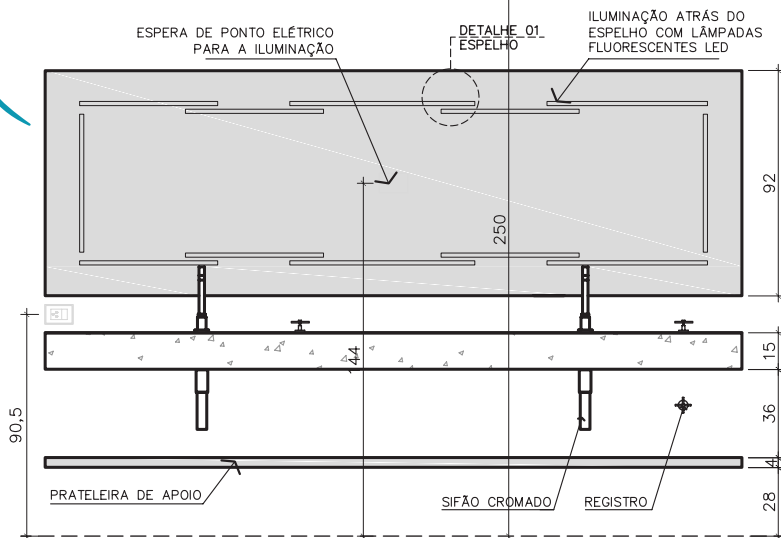

DETALHE ESPELHO COM ILUMINAÇÃO

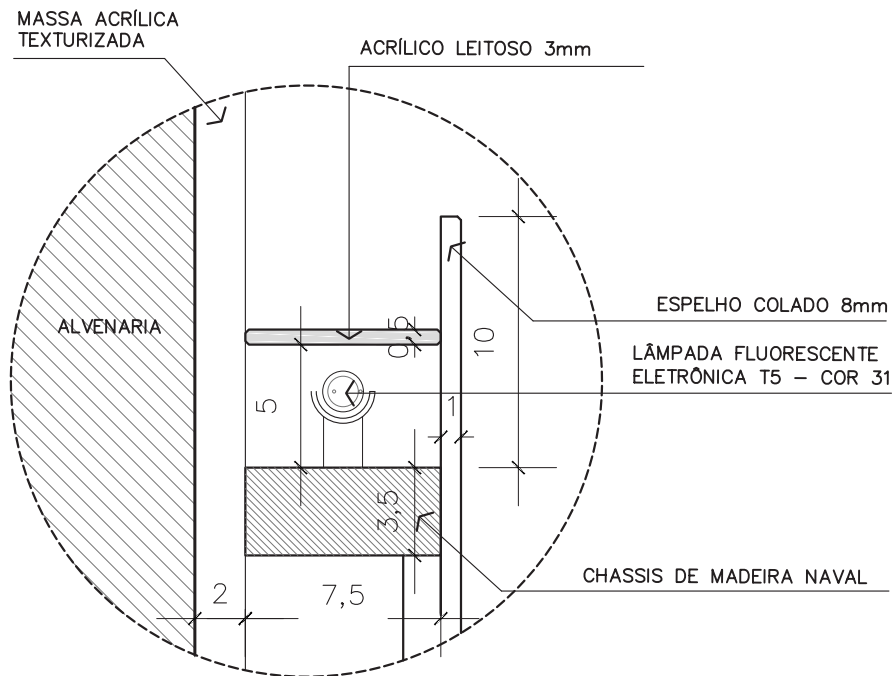

BANCADA BANHEIRO - CORTE

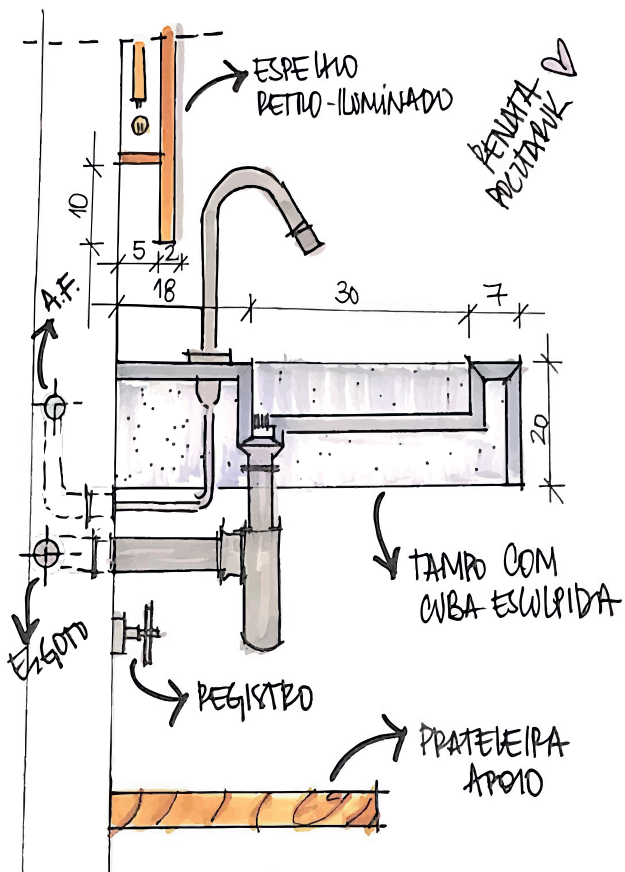

DETALHE RIPA

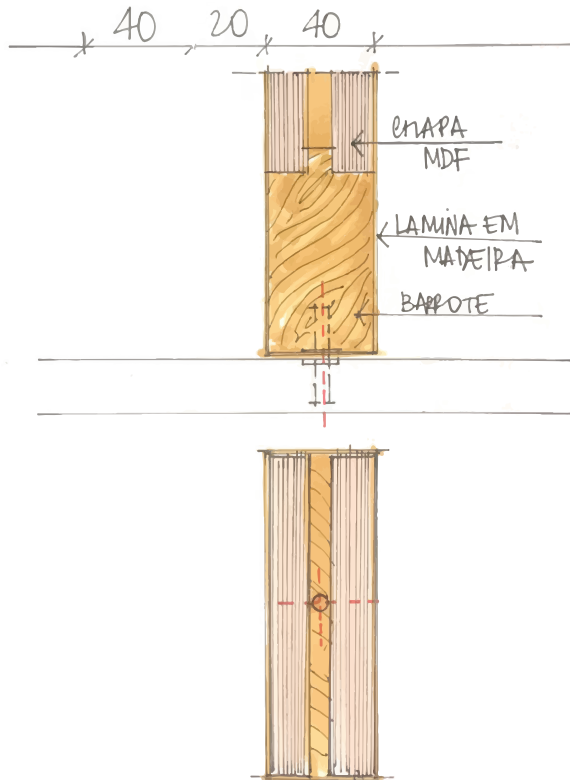

PORTA COM CAVA - CORTE

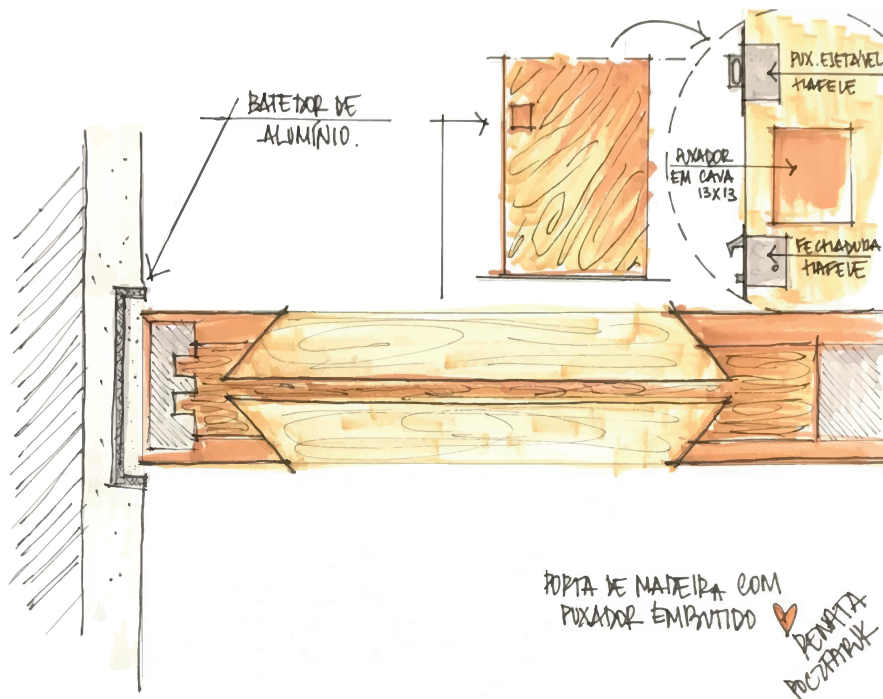

DISTÂNCIA DO SOFÁ PARA TELEVISÃO

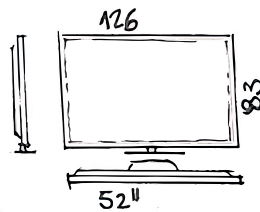
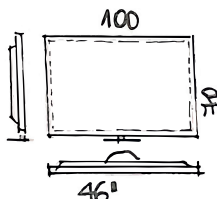
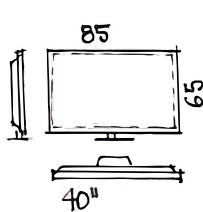

* MEDIDAS PODEM VARIAR DE MARCA P/ MARCA

RENATA BORTOLETI

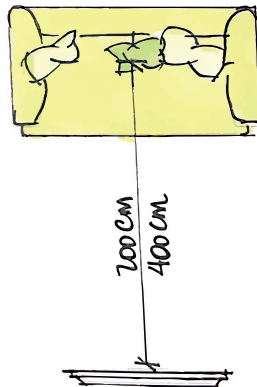
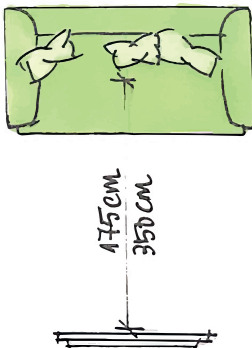
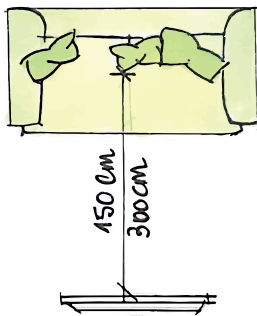

GAVETAS COM CAVA

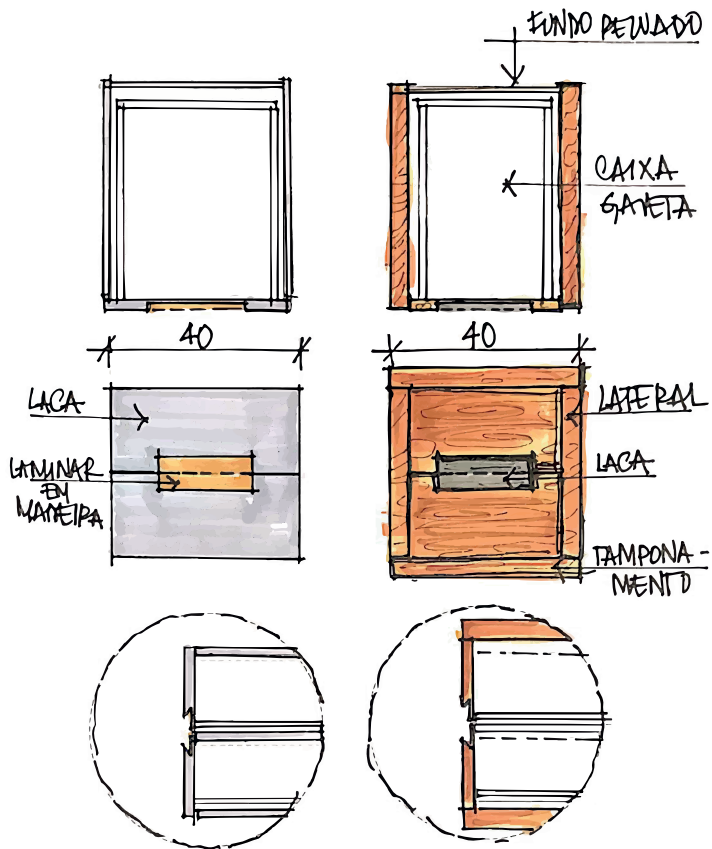

GAVETA COM CAVA - CORTE

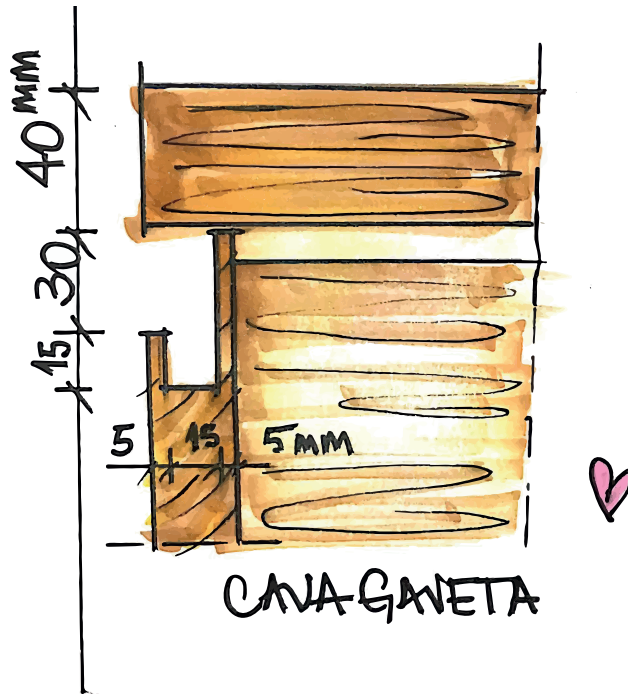

JARDIM VERTICAL - CORTE

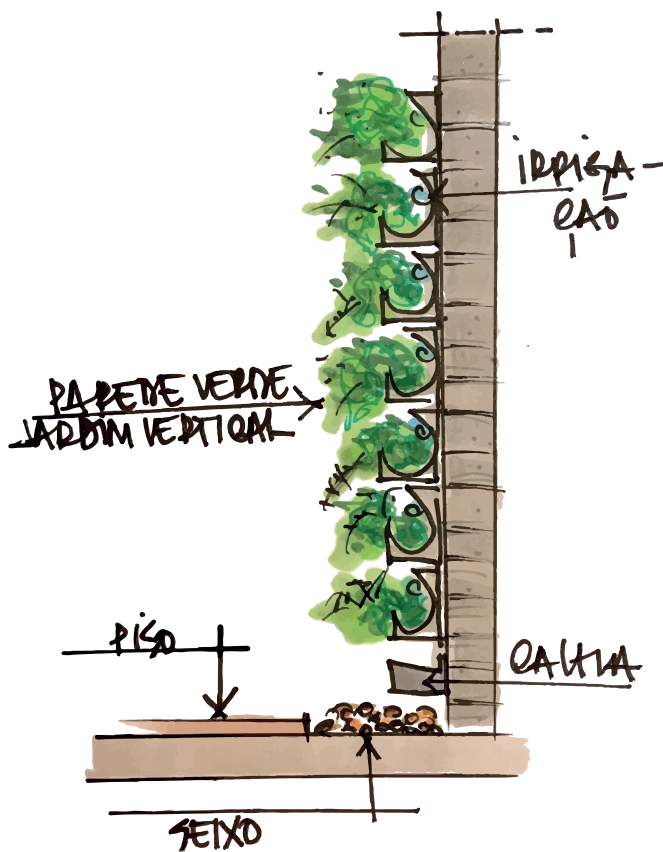

CAMARIM - VISTA

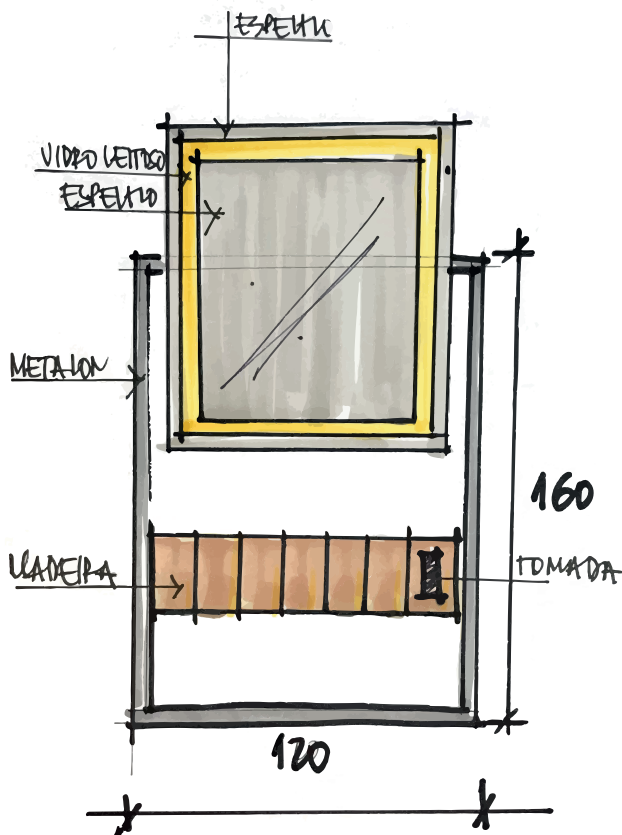

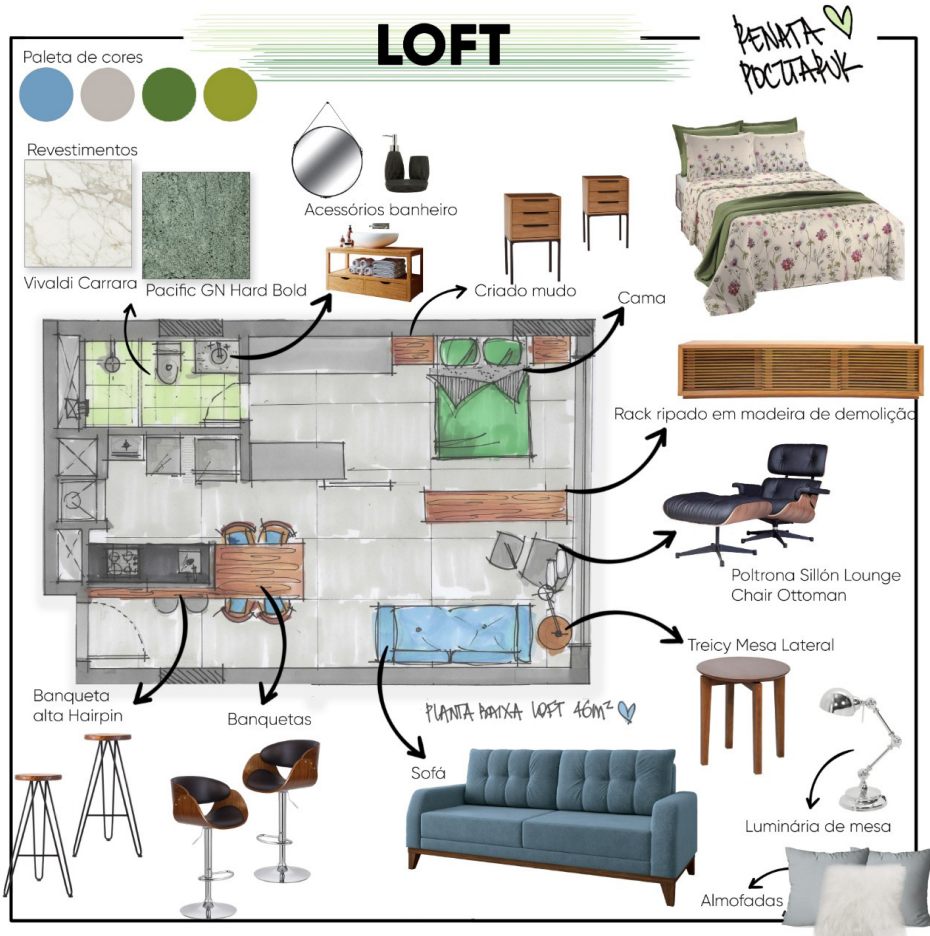

PLANTA BAIXA

#dicadodia



